



Government of The People's Republic of Bangladesh

Ministry of Local Government, Rural Development and Co-operatives

Emergency Multi-Sector Rohingya Crisis Response Project (EMCRP)

Local Government Engineering Department (LGED)



Report on Outcomes of Social Screening on Proposed Establishments of Six (6) Women Friendly Space (WFS)

Funded by:



Government of the People's Republic of Bangladesh & World Bank

Report Produced in favor of UNFPA by:



Development Design Consultants Ltd.

March 2021

Contents

1. Background of the project:	1
2. Location of Sub project	1
3. Map of Cox's Bazar District with Project Location	3
4. Project Goal and objectives:	5
5. Methodology	5
6. Summary of Key Findings:	5
6.1 Summary impacts:	5
6.2 Existing Scenario of Proposed WFS:	6
6.3 Users Opinion:	6
6.4. Construction induced impact issues:	6
6.5 Construction Yard and requisition of land (if required):	7
6.6 Impact Mitigation Measures:	7
7. Consultation	7
Table: 1: Summary of Consultation Meetings/ FGDs participant's number	8
Table: 2: Attendance of Women Friendly Space (DRP) Consultation as follows	9
8. Positive impacts by the WFS:	11
9. Social Management Plan (SMP):	11
10. Recommendations:	17
11. Conclusions:	17
Annex-01: At a Glance Key Findings by Social Screening of 6 (Six) Women friendly space (WFS).	18
Description of women friendly space (WFS) (According to field data)	19
Annex-02: Pictures of Present Condition & location of 6 women friendly Space (WFS):	20
Annex-03: Social Screening of Camp 8W, Block-F, Women Friendly Space (WFS), Ukhiya	22
Annex-04: Social Screening of Camp 12, Block-G, Sub Block-G14, Women Friendly Space (WFS), Ukhiya.	27
Annex-05: Social Screening of Camp 14, Block- A-2, Hakimpara, Friendly Space (WFS), Ukhiya.	32
Annex-06: Social Screening of Camp 9, Block-C, Sub-Block-C12, Women Friendly Space (WFS), Ukhiya.	37
Annex-07: Social Screening of Teknaf -Nayapara registered refugee camp, Block-H, Women Friendly Space (WFS), Teknaf.	42
Annex-08: Social Screening of Camp-06, Block- D, Hill-11, Sub Block-C2, Women Friendly Space (WFS), Ukhiya.	47
Annex-09: Screening Findings and Mitigation Measures	52
Annex-10: At a Glance Public Consultation of 6 sub-projects (WFS)	54
Annex-11: Photographs of Consultation Meeting with Stakeholders of 6 (Six) WFS.	54
Annex-12 to 17: List of Participants Attended in a Consultation Meeting of 6 WFS.	55
Annex-18 to 31: List of Land/House Agreement & Acknowledgement of 6 WFS.	62

Abbreviations

Abbreviations	Descriptions
ARIPA	Acquisition and Requisition of immovable property Act;
BC	Bituminous Carpeting
BFS	Brick Flat Soiling
BOQ	Bill Of quantity
CBO	Community Based Organization
CoC	Code of Conduct
CSO	Civil Society Organization
DOE	Department of Environment
DoF	Department of Forest
D&SC	Design & Supervision Consultant
EMCRP	Emergency Multi-Sector Rohingya Crisis Response Project
ESMF	Environmental and Social Management Framework
FGD	Focus Group Discussion
GPS	Government Primary School
GRC	Grievance Redressed Committee
GRM	Grievance Redressed Mechanism
HBB	Herring Bone Bond
IUCN	International Union for Conservation of Nature
LGED	Local Government Engineering Department
LGRD	Ministry of Local Government, Rural Development and Co-operatives
N/A	Not Applicable
NGO	Non-Government Organization
OP	Operational Policy
PDO	Project Development Objective
PIU	Project Implementation Unit
PWD	Persons with Disabilities
PRA	Participatory Rural Appraisal
RCC	Reinforced Cement Concrete
RF	Resettlement Framework
RRRC	Refugee Relief & Repatriation commissioner
RoW	Right of Way
RPF	Resettlement Policy Framework
SMP	Social Management Plan
SRH	Sexual and Reproductive Health
SASA	Start Awareness Support Action
TP	Tribal People
TMP	Traffic Management Plan
TCP	Traffic Control Plan

1. Back Ground of the Project:

The Project is targeting Displaced Rohingya Peoples (DRP) and host communities in the affected areas of Ukhiya and Teknaf to ensure lifesaving Gender Based Violence (GBV) services and prevention activities to mitigate the GBV. UNFPA is the United Nations sexual and reproductive health agency to implement Providing Quality GBV Prevention, targeted to access basic services and aims to focus on developing community considering for protection groups, empowering community to provide a safe community for their women and girls and Response for the Rohingya and Host Communities in Cox's Bazar to increase community wellbeing along with NGO (Mukti Cox's Bazar) financed by World Bank.

The project, with the expansion of comprehensive GBV services, bringing new community mobilization approach SASA (start awareness support action). Together, where it involves everyone and engages a critical mass of people across all levels of society in order to create social norm changed, social cohesion between refugee and host communities will be fostered by facilitating joint activities between communities; by extending more assistance to host communities in Ukhiya and Teknaf.

Twenty Women Friendly Spaces (17 for Rohingya refugees, two for host community, one mixed) serving the camps and host communities, providing them access to midwifery and other important services for protection and well-being index over time.

This screening report has been prepared for 6 WFS under UNFPA which are operating (partial) as 1 rented house and 5 rented open places have been selected for construction and improvement in DRP camp. These establishments will improve by the UNFPA targeted to access basic services and aims to focus on developing community considering for protection groups, empowering community to provide a safe community for their women and girls. EMCPR has been targeted to improve high risk population and marginalized groups into all the activities of GBV prevention for the displaced Rohingya population and host communities. These screening reports are being prepared for 6 WFS situated in DRP camp following the guidelines of ESMF and RPF. Detail's list of sub projects is mentioned below (SL # 2). LGED & D&SC team has conducted social screening as per suggestion of World Bank & UNFPA and results indicates that 1 selected rented places will be constructed for WFS building and 5 WFS will be improved in rented open space.

2. Location of Sub project

Name of District	Name of Upazila	Name of Women Friendly Space (WFS)	Total Space of WFS approved by RRRC (Square Feet)	Total Space of new construction Women Friendly Space (WFS) (Square Feet)	Work area of Women Friendly Space (WFS)		Tentative Facilities of Women Friendly Space (WFS)	Remarks
Cox's Bazar	Ukhiya	Camp 8W, Block-F, Women Friendly Space (WFS), Ukhiya	-	1192.00	-	DRP	<u>Tentative Facilities of New Construction WFS:</u> Meeting room-1, Counseling room-1, Mid wife room-1, Office room-1, Corridor-1, Store room-1, Guard room-1, Generator room-1, PSS activities room-1,	Annex -18-31: Agreement & Acknowledgements are Attached
	Do	Camp 12, Block-G, Sub Block-G14, Women Friendly Space (WFS), Ukhiya	-	1192.00	-	DRP		
	Do	Camp 14, Block- A-2,	-	1821.15	-	DRP		

		Hakimpara, Friendly Space (WFS), Ukhya					Latrine-1/2 & Bath room-1/2 <u>Tentative Facilities</u> <u>of Camp-06, Block-</u> <u>D, Hill-11, Sub</u> <u>Block-C2, Women</u> <u>Friendly Space (WFS),</u> <u>Ukhya: -</u> Meeting room-1, Counseling Room- 3, Mid-Wife Room- 1, Toilet-1, adolescence care room-1 & Corridor.	
	Do	Camp 9, Block-C, Sub- Block-C12, Women Friendly Space (WFS), Ukhya	-	1821.15	Host	DRP		
	Teknaf	Teknaf - Noyapara registered refugee camp, Block- H, Women Friendly Space (WFS), Teknaf	-	1821.15	Host	DRP		
	Ukhya	Camp-06, Block- D, Hill-11, Sub Block-C2, Women Friendly Space (WFS), Ukhya	780.00	-	-	DRP		

3. Map of Cox’s Bazar District with Project Location



Map illustrating 6 (Six) nos. Women friendly spaces (WFS) locations in the Ukhiya & Teknaf Upazila

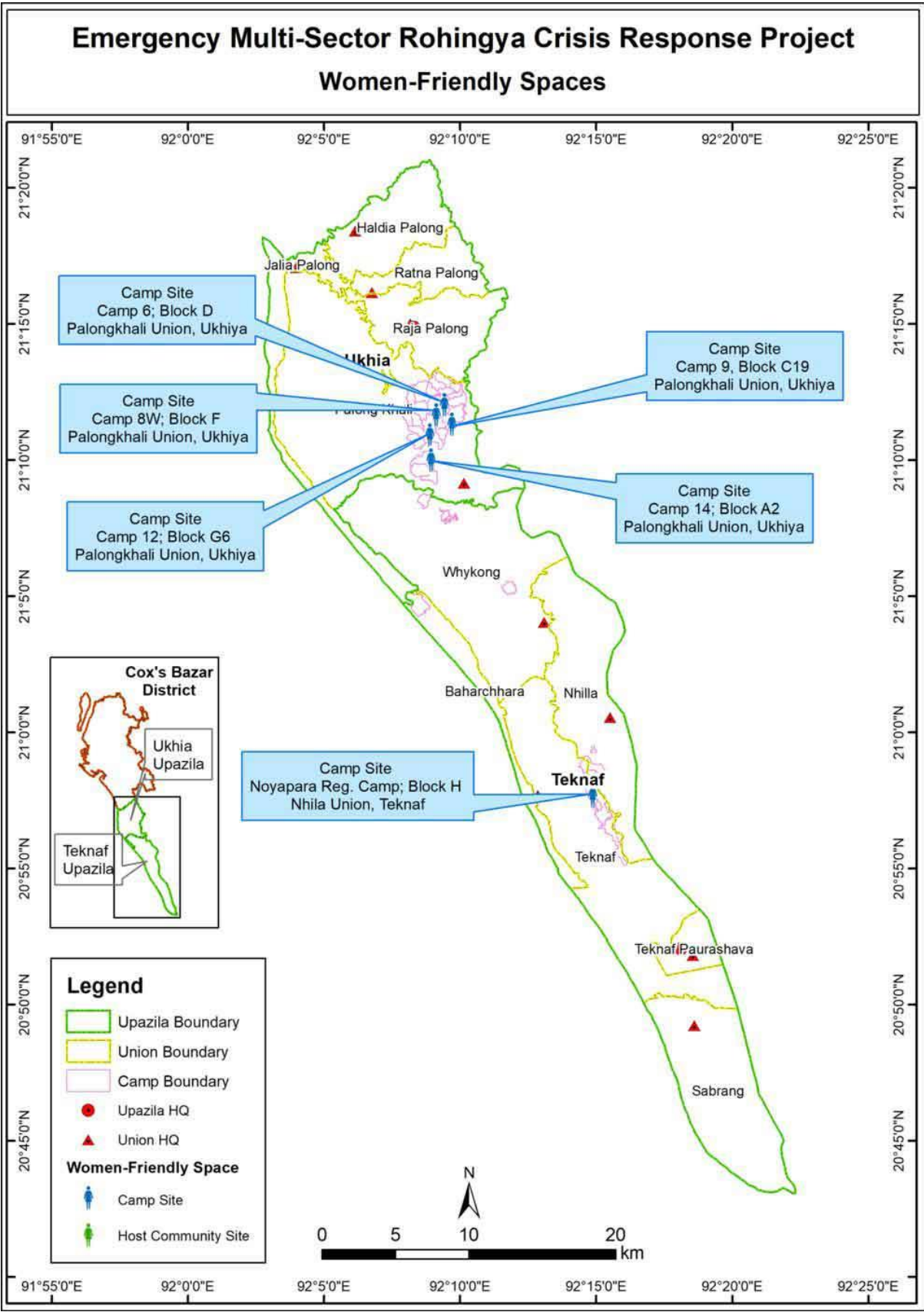

4. Project Goal and objectives:

Goal: Advance gender equality, women's and girls' empowerment and reproductive right, including for the most vulnerable and marginalized women, adolescent and youth right will be ensured.

Objective: Gender Based Violence in Emergency (GVBiE) Project aims to save the lives and dignity of the women and girls from Rohingya and host communities as well.

5. Methodology

A team consisting of social and environment Specialists of PMU and a design & supervision consultant visited the 6 sites of WFS and conducted focus group discussion (FGD) with relevant stakeholders and participated in formal and informal interactions with host community and the DRP Camp Rohingya peoples. A structured questionnaire was used to obtain necessary primary data relating to location and land acquisition requirement, land ownership, losses of land, assets and other factors. Further information's were gathered through interviews of key informants and most importantly stakeholder consultation meetings through a FGD approach to capture the female and male people's opinion and feedback about the WFS improvement.

6. Summary of Key Findings:

6.1 Summary impacts:

Proposed WFS will be improved on a part of existing established rented house and newly construction of rented open place. All are established in a private place which is rented by UNFPA and its local partner Mukti Cox's Bazar. An agreement has been made in between land owner and implementation NGO Mukti (See Annex-30). Social Screening survey confirmed that 1 WFS will be established rented building and another 5 WFS will be established in a rented open place. Social Screening surveys found that in open place there are fully vacant place, so no trees which are require to cut off & mitigation measures shall be needed according to RPF. We would like to mention that. Based on results of social screening it has confirmed that CPR structures will not be affected. WFS will not cause any negative livelihood impacts; even WFS will not affect any structures, Community properties or any assets.

We are expecting the following potential positive impacts may achieve during WFS functioning such as;

- Individual women and girls are participated in the awareness and information session at the WFS and received information on different WFS services, referral and awareness on different issues including GBV, PSS and COVID-19 prevention messages. As per Information has been collected in November 2020 that, 36 awareness and 12 consultations has conducted and more than 250 women girls and adolescent was attended in the program, see attended picture in Annex-11.
- They received integrated service and expressed their satisfaction that came from the Client Satisfaction Survey.
- Women and girls took part in psycho social support activities. These activities provided opportunities for social networks, solidarity building among women and girls contributing to their safety, healing and restoring their dignity as well.
- Women and Girls received services for the first time from WFS. Like; COVID-19 related awareness session, Dignity Kit, Case management, PSS activities, referral service, WASH support and also for socializing/leisure. It will be changed their lives a lot.
- Women and adolescent will be reached through community mobilization. Especially focus on Persons with Disabilities (PWD) and their family members and activated women support group members as well.
- By awareness sessions for disabled women learnt about their abilities and felt confident. Raised

awareness among themselves about the information and services as their needs and knew where they have to go for getting these services. Side by side a role was broadly discussed about caregivers as the PWD household members. After conducting sessions, the caregiver committed to extra care for the PWD and now they believe that PWD individuals can also contribute to the family as well as society.

Even though, we are anticipating and conscious about the possible impact may be occurred during construction of 3 WFS tin shed building and obviously take necessary steps as against the impact and will resolve public issues by working with the DRP camp and host community to address the potential impacts as such;

- Rapid changes in the price of necessary goods due to influxes workers. It also leads to abrupt changes to livelihood systems.
- Due to recruits' male workers from outside Rohingya people may face many new diseases. It may cause of some potential risk of GBV/ new diseases. LGED has assured the community that, the construction contractor shall be look after the matter and to take mitigation measures.
- Unexpected loss of social and cultural relationship between social groups may hamper

However, due to change of alignment or if any new impacts are identified, mitigation measures will be taken according to RPF and ESMF. No tribal people are identified during screening. No squatters will be affected by the project.

The social team has been felt that the process of on-going communication and public involvement ultimately aided in streamlining the process by dealing with issues before they became problems. Overall, the project impact will be positive.

6.2 Existing Scenario of Proposed WFS:

The project does not have any land acquisition or population displacement, as 1 (One) WFS will be operated in existing monthly rented houses and 5 WFS will be operated in open places which will be constructed by UNFPA. As WFS are being established within the DRP camp 6 (Six) no's and consulted by several meeting which are reflected in consultation outcomes table-2. During screening, one open place found some trees other open places are vacant fallow land, no Common Properties or any other permanent assets will not be affected by the project. However, during implementation, if any impacts are identified, those will be addressed following the guidelines of EMCRP RPF and ESMF. Scenarios of key findings are attached in Annex-1.

6.3 Users Opinion:

In view of consultation with the host and DRP camp communities it has revealed that, after establishment of these proposed WFS the Gender base violence will be decreased at servings and fulfill access related need's goal. Health facilities for women and adolescent will be increased and by awareness sessions for disabled women learnt about their abilities and felt confident and female and girls will get benefit for these WFS particularly for the pregnant mother(s) and serious patients. Because there are 2 doctors for 6 WFS and 1 midwife for each WFS, 5 Case workers for each WFS, 1 case Manager for 6 WFS and 8 Volunteer for each WFS are available in WFS within office hour.

6.4. Construction induced impact issues:

Since, 3 WFS is being implemented in private-owned rented land, there is no land acquisition needed but when construction new semi pacca building some trees shall be needed to cut off to implement these projects. However, during construction of WFS heavy vehicles for carrying construction materials may

cause damage of road or assets. If any damages are reported, UNFPA will hold consultations with host community with contractors to take mitigation measures according to ESMF and RPF.

In addition, UNFPA has been suggested to construction contractors that to avoid damage of connecting roads, contractor shall be mobilized construction materials along strong paved road or highway then bring it at site by small motorize and non-motorize vehicles or using alternative.

6.5 Construction Yard and Requisition of land (if required):

The UNFPA has conducted necessary consultations with stakeholders regarding the construction yard. As discussed, it has been confirmed that the contractor will use vacant government land as a construction yard during the construction of WFS tin shed building. In the event that the contractor needs additional land for the construction yard and no government land is available, land can be rented from the private landowners for a certain period. However, if UNFPA prefer to requisition the land, the following steps will be followed.

For requisition of land for temporary purposes, the Acquisition and Requisition of Immovable Property Act 2017 (ARIPA) is the principal legislation governing eminent domain land acquisition and requisition in Bangladesh. The Act requires compensation to be paid for: (i) vacating the requisitioned property (ii) reoccupying the property upon release from the requisition (iii) damaged, the cost to the property during the period of requisition including the expenses that may have to be incurred for restoring to the original condition.

Under the ARIPA 2017, The Deputy Commissioner (DC) determines the value of the requisitioned assets under section 22 (1) and 22 (2) with due consultation with the landowners. According to section 22 (6), requisition is allowed only for 2 years. If land is required more than 2 years, a new contract is required with the land owners with an agreed compensation rate. Under section 23, DC will pay the compensation to the land owners. If the land requisitioned has standing crops cultivated by a tenant (Market Price) under a legally constituted written agreement, the law requires that compensation money be paid in cash to the tenants as per the agreement. Under no circumstances, land requisition is not allowed due affecting residential and community properties. However, under section 20, requisition is only allowed for emergency road repairing. Any losses for structures, trees, and business will follow the provisions of ARIPA 2017.

However, land will not be required for constructor because there is available vacant land for the owner of rented open space.

6.6 Impact Mitigation Measures:

Apart from the land required for the WFS, more land is required for the WFS construction sites for establishing temporary facilities, such as contractor labor shed, materials stack yard and store etc. In such cases, the contractor can arrange land for temporary works from outside of the alignment. At the WFS sites where work will begin, UNFPA will make sure the land is free and available in consultation with the owners are adequately compensated in cases of private land being used, without subjecting them to undue influence or force.

In addition, the contractor will make sure construction area is clearly marked with signage as construction work underway. All signage shall be provided with good conditions with ease of movement and adequate space.

7. Consultation

Consultation involves interaction with relevant stakeholders to inform them about the WFS projects. Involving stakeholders in the process will ensure that the opinions and concerns of various groups are taken

into account to facilitate a smooth execution of projects.

Total 51 numbers participants were attended in the consultation meeting shown in table -1. The social safeguard team of EMCRP has conducted a stakeholder consultation meeting at respecting area an active participation of DRP communities were attended the consultation and provided valuable opinions/suggestions/feedbacks regarding the WFS implementation. DRP participants list with date, summery of consultation/FGD outcomes are mentioned below table 1 & 2 and summery of consultation outcomes;

Table: 1: Summary of Consultation Meetings/ FGDs participant's number

No.	Date	Main Participant Groups	No. of Participants		Total
			Male	Female	
1	11/02/2021 & 13/02/2021	Local Stakeholders (DRP)	0	51	51
Total participants =			0	51	51

Summary of Consultation Outcomes

- Effective collaboration held on the consultation/ FGD meeting between the stakeholders and implementing agency regarding these proposed project implementations.
- Ensuring various stakeholders' participation, which will enhance their sense of belonging in the proposed sub-projects?
- Identifying unavoidable adverse impacts and ensure effective mitigation measures.
- Ensuring social conflicts and grievance management during construction of WFS semi pacca building.
- Following labor laws strictly, including recruitment of child labor, adequate code of conduct for all
- Labor, wages, avoiding discrimination between male and female workers etc.
- Ensuring equal wages for female labor including site security and facilities.
- Ensuring that GBV is not occurring at the work site. If happen then mitigation measure will be ensured under the guidance of UNFPA. Availability of first-aid boxes at the proposed projects site.
- Training for concern stakeholders regarding social safety & security, labor influx, among others.
- Avoiding and minimizing adverse social impacts for the proposed WFS.
- If trees are requiring to cut-off, compensation will be given to the owner of the tree/s according to the guidelines of RPF.

Table: 2: Attendance of Women Friendly Space (DRP) Consultation as follows

Sl. #	Name of Women Friendly Space	Date of Meetings	Meeting Places	Number of Participants				Total	Issues Discussed	Replied by LGED
				Host		DRP				
				Male	Female	Male	Female			
	Camp 8W, Block-F, Women Friendly Space (WFS), Ukhiya	11/02/2021	Nur Ahmed’s Shop, Camp 8W, Sub-Block-H61	-	-	-	7	7	The following issues were discussed during the consultation meeting with DRP Camp stakeholder; 1. Who will implement the WFS? 2. Activities of the WFS? 3. Are there any Doctor? 4. Who will coordinate with construction work? 5. Will ensure Safety issues within construction area? 6. Asked about GBV or other harassments.	UNFPA is overall responsible for the project implementation, through their local partner Mukti Cox’s Bazar. Mukti Cox’s Bazar is overall responsible for the rented houses and construction of structures in open places. Providing psychosocial support to GBV and Non GBV survivor’s women and girls. Case management of GBV survivors. Provide Referral Services to the GBV and NonGBV survivors women. Awareness Information Session in WFS. Awareness Information Session at outreach. Recreational activities for women and adolescents’ girls. Develop and Disseminate IEC and BCC materials (Early marriage, puberty, HIV/AIDS, Hygiene etc. Form and functioning Women Support Group (WSG). Community Watch Group formation and functioning (CWG). Awareness raising session to reach women and girls with disabilities, distribution of
2	Camp 12, Block-G, Sub Block-G14, Women Friendly Space (WFS), Ukhiya	11/02/2021	House of Hafez Majhi, Block-G, Sub-Block-G14	-	-	-	10	10		
3	Camp 14, Block- A-2, Hakimpara, Friendly Space (WFS), Ukhiya	11/02/2021	House of Sabir Majhi, Block-A, Sub-Block-A-2	-	-		10	10		
4	Camp 9, Block-C, Sub-Block-C12, Women Friendly Space (WFS), Ukhiya	13/02/2021	House of Nur Kalam Majhi, Block-C, Sub-Block-C-12	-	-	-	8	8		
5	Teknaf - Noyapara registered refugee camp. Block-	13/02/2021	Sun Flower Model Primary	-	-	-	8	8		

	H, Women Friendly Space (WFS), Teknaf		School, Block-H						
6	Camp-06, Block- D, Hill-11, Sub Block-C2, Women Friendly Space (WFS), Ukhiya	13/02/2021	Women & Girls Safe Space, Block-D, Sub-Block-C2	-	-	-	8	8	
Total participants =				-	-	-	51	51	

Dignity Kits to the women and girls of re-productive age

Coordination meeting with other service providers for strengthening referral pathway for ensuring SRHR services and COVID19 awareness

COVID19 Kit distribution. -yes, 2 doctors for 6 WFS and 1 midwife for each WFS are available in 6 WFS. Health and safety training shall ensure to the labors during construction for safety and ensured satisfactory mitigation measures as against any adverse impact. GBV training at the work sites will be ensured before the start of construction work to Prevent GBV. Contractor need to engage local labor as well Rohingya labor (male and Female) priority during their construction work. Contractor shall make sure the temporary barricade surrounding construction areas for traffic movement as well as safety measurement maintain stickily.

8. Positive impacts by the WFS:

The proposed services implementation will contribute to better socio-economic conditions and will have positive impacts on the quality of life of the DRP and local community women and girls. The social opportunities that will contribute positive impacts are given below;

- Psychosocial support to GBV survivors and other women and girls will be ensured.
- Case management of GBV survivors for women and girls
- Referral Services will be provided to the -GBV survivors and other women who need the services.
- Women and girls will get awareness Information Session in the WFS.
- Socially and culturally accepted recreational activities for women and adolescents' girls will be provided.
- Awareness building through IEC and BCC materials (Early marriage, puberty, HIV/AIDS, Hygiene etc.) among the participants.
- Women Support Group (WSG) will be formed.
- Formation of Community watch group and make them functional Awareness raising session to reach women and girls with disabilities.
- Distribution of Dignity Kits to the women and girls of re-productive age. Coordination meeting with other service providers for strengthening referral pathway for ensuring GBV services and sexual and reproductive health and rights services (SRHR).
- COVID-19 awareness session including COVID-19 Kit will be provided

9. Social Management Plan (SMP):

Based on public consultation, a Social Management Plan identifies the mitigation and management activities that need to be in place in order to eliminate the marginal social impacts or to reduce them to an acceptable level and the process will be continued subsequently. Site-specific mitigation plans are given below;

Potential Social impacts/ Issues	Proposed Mitigation Measures	Project stage	Institutional responsibility	Supervision Responsibility
Loss of land / and other physical assets	<ul style="list-style-type: none">• No land acquisition will be required as WFS is being established rented houses inside and outside of the camp.• We expecting no grievances will be found from the neighboring in the project sites. If found grievance from the site, UNFPA will consult on emergency basis in order to solve the problems in consultation with CIC and host community.	Pre-Construction stage	UNFPA	Chief Executive Officer, Mukti, Cox's Bazar.
Loss of Trees	<ul style="list-style-type: none">• Cash compensation will ensure and will incur in BOQ for fruits bearing trees based on annual net product market multiplied by productive years.• Cash compensation equivalent to prevailing market price of timber	Pre-Construction stage	UNFPA	Chief Executive Officer, Mukti, Cox's Bazar.

	for non-fruit trees.			
Stakeholders Engagement	<ul style="list-style-type: none"> All the project stakeholders will be consulted. All the safeguard documents will be disclosed to all the relevant stakeholders before the start construction works. Consultation meeting with host and Rohingya male and female about the project objectives and scope of works. 	Pre-Construction stage	UNFPA	Chief Executive Officer, Mukti, Cox's Bazar.
Loss of right to access induced impacts.	<ul style="list-style-type: none"> In case of unavoidable circumstances, alternative access will be provided. Mitigation measures will be taken at the satisfactory level after discussion with host community and DRP camp management. 	Pre-Construction stage	UNFPA	Chief Executive Officer, Mukti, Cox's Bazar.
Site Selection & implementing interventions: Human-elephant conflict	<ul style="list-style-type: none"> Selection of sub-project sites and all implementing interventions must take place outside of the elephant corridor/influence area. Elephant Human conflict need to be avoided. <p>A consultation will be made with CIC during site selection in side Camp.</p>	Pre-Construction stage	UNFPA	Chief Executive Officer, Mukti, Cox's Bazar.
Site Preparation: Soil Erosion; Alteration of natural drainage	<ul style="list-style-type: none"> Construction facilities including material are to be placed at least 30 meters away from any water body in order to minimize impacts on water bodies and natural flow paths. Any disruption of socially sensitive areas with regard to human habitation and areas of cultural significance will be avoided. <p>The contractor shall ensure that site preparation activities do not lead to disruption of activities of the local residents</p>	Pre-Construction stage	UNFPA	Chief Executive Officer, Mukti, Cox's Bazar.

Safety Issues	<ul style="list-style-type: none"> • An unauthorized person entry to the proposed site shall be restricted and proper storage and control of hazardous materials on Construction stage UNFPA Chief Executive Officer, Mukti Cox's 11 site ensured. • Health and safety training should be ensured to the Rohingya labors. • All the camp labors to bear ID cards. • Child labors are not allowed for any form of activities. • Site(s) shall be secured by fencing and by fencing and ridge (if needed). • Ensuring that clear safety policies and procedures are in place and strictly enforced is essential, as is regular inspection and maintenance of all workplace equipment. • To be ensured immediately testing for COVID-19 affected labor even ensures testing for everybody working together and urgently consult with health experts. Contractor will take necessary measures with prior consent of Mukti Cox's Bazar. 	Construction stage	UNFPA	Chief Executive Officer, Mukti, Cox's Bazar.
Quality construction work of the WFS	<ul style="list-style-type: none"> • Respected community deserving quality construction works as per design. 	Construction stage	UNFPA	Chief Executive Officer, Mukti, Cox's Bazar.
Safety during construction of the WFS	<ul style="list-style-type: none"> • Awareness building program will be taken on social safety matters through providing training from the project before commencement. • At the same time, compliance will be ensured by the contractors. 	Construction stage	UNFPA	Chief Executive Officer, Mukti, Cox's Bazar.
Drinking water and sanitation facility for male and female workers	<ul style="list-style-type: none"> • Construction hosts shall have adequate drinking water facility by ensuring water filter, water sealed latrines, urinals and appropriate bathing facilities. 	Construction stage	UNFPA	Chief Executive Officer, Mukti, Cox's Bazar.

Noise from construction works	<ul style="list-style-type: none"> Construction activity shall be restricted to daytime as far as possible to avoid noise and sound pollution. 	Construction stage	UNFPA	Chief Executive Officer, Mukti, Cox's Bazar.
Followed PPE	<ul style="list-style-type: none"> Wherever required, personal protective equipment (PPE) such as ear plugs, earmuffs, helmets, etc. will be provided by the contractor to the persons working in high-risk areas. 	Construction stage	UNFPA	Chief Executive Officer, Mukti, Cox's Bazar.
Labour Base Host: Conflicts with the local residents	<ul style="list-style-type: none"> An alternate arrangement for fuel Construction UNFPA Chief 12 Conflicts with the local resident's wood, heating and cooking should be arranged for the labors at labor camp. Awareness building about nutrition, disaster risk resilience or mitigation, adoption of clean energy for cooking; and prevention of child abuse, child marriage, GBV, sexual harassment, trafficking of women and children as well as illegal drug trade. Work force should be prohibited from disturbing the flora, fauna including hunting of animals, wildlife hunting, poaching and tree felling. Treated water will be made available at site for labour drinking purpose. Adequate accommodation arrangements for labour and code of conduct to be disclosed through consultation and FGD. 	Construction stage	UNFPA	Chief Executive Officer, Mukti, Cox's Bazar.
Health & Safety Risks	<ul style="list-style-type: none"> The potential for exposure to safety events such as tripping, working at height activities, fire from hot works, smoking, failure in electrical installation, mobile plant and vehicles, and electrical shocks. Exposure to health events during construction activities such as manual handling and musculoskeletal disorders, hand arm vibration, temporary or 	Construction phase	UNFPA	Chief Executive Officer, Mukti, Cox's Bazar.

	<p>permanent hearing loss, heat stress, and dermatitis.</p> <ul style="list-style-type: none"> • The risk assessment shall be prepared and communicated prior to the commencement of work for all types of work activities on site. • Carry out fire risk assessment for the construction areas, identify sources of fuel and ignition and establish general fire precautions including, means of escape, warning, and fighting fire. • Set up a system to alert workers on site. This may be temporary or permanent mains operated fire alarm. • Fire extinguishers will be located at identified fire points around the site. The extinguishers shall be appropriate to the nature of the potential fire. • Establish and communicate emergency response plan (ERP) with all parties, the ERP to consider such things as specific foreseeable emergency situations, organizational roles and authorities, responsibilities and expertise, emergency response and evacuation procedure, in addition to training for personnel and drills to test the plan. • Electrical equipment must be safe and properly maintained; works shall not be carried out on live systems. • Only competent authorized persons shall carry out maintenance on electrical equipment, adequate personal. • Electrical equipment must be safe and properly maintained; works shall not be carried out on live systems. • Only competent authorized persons shall carry out maintenance on electrical equipment, adequate personal. • Protective Equipment (PPE) for electrical works must be provided to all personnel involved in the 			
--	--	--	--	--

	<p>tasks. • An adequate number of staff and first aiders shall be on site in accordance with Bangladesh Labor Law requirements.</p> <ul style="list-style-type: none"> • First aid kit with adhesive bandages, antibiotic ointment, antiseptic wipes, aspirin, non-latex gloves, scissors, thermometer, etc. shall be made available by the contractor on site. • Emergency evacuation response shall be prepared by the contractor and relevant staff shall be trained through mock-up drills. • Ensure all equipment is suitable for jobs (safety, size, power, efficiency, ergonomics, cost, user acceptability etc.), provide the lowest vibration tools that are suitable and can do the works. • Ensure all tools and other work equipment are serviced and maintained in accordance with maintenance schedules and manufacturer's instructions. • Regular noise exposure assessments and noise level surveys of noisy areas, processes and equipment shall be carried out in order to form the basis for remedial actions when necessary. • Awareness training sessions will be established and provided to all personnel involved during the construction phase in order to highlight the heat related illnesses of working in hot conditions such as heat cramps, heat exhaustion, heat stroke, dehydration. • Eliminate the risk of exposure whenever possible, provide proper PPE wherever necessary and to ensure that there are satisfactory washing and changing facilities. • Ensure that all workers exposed to a risk are aware of the possible dangers. They will be given thorough training in how to protect themselves and there will 			
--	--	--	--	--

	be effective supervision to ensure that the correct methods are being using. <ul style="list-style-type: none"> Based on ESMF construction, contractor will deploy Social Safeguard officer to ensure safety measures. 			
The sub-projects are expected to be sustainable	<ul style="list-style-type: none"> The safeguard issues and maintenance of the WFS will be taken care of by the concerned Union Parishad and Upazila Parishad for sustainability. 	Operation & Maintenance	Union council and Upazila Parishad	LGED and Local Governance institution
Health & safety risks to workers & Local community/DRPs <ul style="list-style-type: none"> Pollution from waste materials Health & Safety risks to workers and local community/DRPs	<ul style="list-style-type: none"> The main mitigation and monitoring measures to minimize or reduce the environmental and social impacts during decommissioning are anticipated to be similar to those identified for the construction phase. 	Decommissioning during the project implementation period (including site clearance after the construction)	PIU, Contractor, D & SC	LGED and Upazila Parishad

10. Recommendations:

Disclosure of all relevant project information during consultation processes with concerned DRP camp and host community absolutely crucial. The involvement of relevant stakeholders in the WFS implementation process will help to build a sense of belonging within the DRP camp. Furthermore, establishing and maintaining an effective Grievance Redress Mechanism (GRM) would enable any affected parties to present their issues and gain equitable solutions to their problems by impartial hearing.

Issues of social safety are important during the construction period of 6 WFS making. Before starting construction work, the stakeholders to be engaged for the construction of WFS will undergo a short orientation course (to be organized by the contractor) on necessary awareness, motivation and compliance of their assigned responsibilities properly.

11. Conclusions:

In conclusion, it can be clearly determined that the WFS will generate tremendous positive impacts for the host community and DRP camp, even peoples of the respected areas will get easy health services in improved environment. Particularly, will ensure the survivors centered approach to offer comprehensive GBV case management services, integrated SRH-GBV services, GBV prevention activities, PSS group activities, individual PSS support, MHPSS support for GBV survivors and women and girls at risk. Adolescent specific curriculum will be implemented to build life skill of the adolescent girls. GBV prevention messages, activities, lifesaving information, referral services to other service points for GBV and NON GBV survivors, structured skill development programme for women and girls through women lead community centers, social mobilization activities through SASA methodology will be ensured in 6 locations of host and DRP settings. GBV response program will be ensured through establish the women friendly spaces for the

peoples of catchment area without any interruption. All these factors will bring an incremental value in their lifestyle and other social aspects for the female and adolescents. Therefore, implementations of the proposed sub-projects are safe and highly recommended.

Annex-01: At a Glance Key Findings by Social Screening of 6 (Six) Women Friendly Space (WFS).

SI #	Name of women friendly space (WFS)	Nature of work	Location of women friendly space (WFS)	Total Space/Land of Each woman friendly space (WFS) (Square Feet)	Actual Space as per design of each woman friendly space (WFS) (Square Feet)	Ownership of Proposed House/Land	Loss of livelihood due to construction/Rent	Status of Land Acquisition (LA) Yes/No	Status of Replacement & Relocation (Yes/No) **	Status of Resettlement Yes/No	Tribal People	Status of Stakeholders Consultation	Recommendation
01	Camp 8W, Block-F, Women Friendly Space (WFS), Ukhiya	Temporary Semi Pacca Tin Shed	Ukhiya Upazila in Cox's Bazar district	1725	1192	Government	No	No	No	No	No	Done	Recommended for implementation
02	Camp 12, Block-G, Sub Block-G14, Women Friendly Space (WFS), Ukhiya	Temporary Semi Pacca Tin Shed	Do	2236	1192	Government	No	No	No	No	No	Done	Recommended for implementation
03	Camp 14, Block- A-2, Hakimpara, Friendly Space (WFS), Ukhiya	Temporary Semi Pacca Tin Shed	Do	4000	1821.15	Rented	No	No	No	No	No	Done	Recommended for implementation
04	Camp 9, Block-C, Sub-Block-C12, Women Friendly Space (WFS), Ukhiya	Temporary Semi Pacca Tin Shed	Do	4000	1821.15	Rented	No	No	No	No	No	Done	Recommended for implementation
05	Teknaf -Noyapara registered refugee camp, Block-H, Women Friendly Space (WFS), Teknaf	Temporary Semi Pacca Tin Shed	Teknaf Upazila in Cox's Bazar district	2800	1821.15	Rented	No	No	No	No	No	Done	Recommended for implementation
06	Camp-06, Block- D, Hill-11, Sub Block-C2, Women Friendly Space (WFS), Ukhiya	IRC Provided temporary structure to be used as respective WFS	Ukhiya Upazila in Cox's Bazar district	1050	780	Government	No	No	No	No	No	Done	Recommended for implementation

Description of women friendly space (WFS) (According to field data)

SI #	Name of WFS	Name of the Upazila	Coordinates	Consulting Meeting Date	Consulting Meeting time	Venue	Participants	Outcomes
01	Camp 8W, Block-F, Women Friendly Space (WFS), Ukhiya	Ukhiya Upazila in Cox's Bazar district	Latitude Value: 21.19442° N Longitude Value: 92.15216° E	11/02/2021	10.30 AM	WFS Area Camp 8W, Sub-Block-H61	Local Stakeholders (DRP & Union Parishad Representatives)	<p>Stakeholders (DRP Camp, Host & Union Parishad Representatives): -</p> <ul style="list-style-type: none"> • Effective collaboration held on the consultation/ FGD meeting between the stakeholders and implementing agency regarding these proposed project implementations. • Ensuring various stakeholders' participation, this will enhance their sense of belonging in the proposed sub-projects. • Identifying unavoidable adverse impacts and ensure effective mitigation measures. • Ensuring social conflicts and grievance management during construction of WFS semi pacca building. • Following labor laws strictly, including recruitment of child labor, adequate code of conduct for labor, wages, avoiding discrimination between male and female workers etc.) • Ensuring equal wages for female labor including site security and facilities. • Ensuring that GBV is not occurring at the work site. • Availability of first-aid boxes at the proposed projects site. • Training for concern stakeholders regarding social safety & security, labor influx, among others. • Avoiding and minimizing adverse social impacts for the proposed WFS. • If trees are requiring to cut-off, compensation will be given to the owner of the tree/s according to the guidelines of EMCRP RPF.
02	Camp 12, Block-G, Sub Block-G14, Women Friendly Space (WFS), Ukhiya	Do	Latitude Value: 21.18208° N Longitude Value: 92.14819° E	11/02/2021	12.45 PM	WFS Area Block-G, Sub-Block-G14	Local Stakeholders (DRP & Union Parishad Representatives)	
03	Camp 14, Block- A-2, Hakimpura, Friendly Space (WFS), Ukhiya	Do	Latitude Value: 21.16667° N Longitude Value: 92.14883° E	11/02/2021	03.00 PM	WFS Area Block-A, Sub-Block-A-2	Local Stakeholders (DRP & Union Parishad Representatives)	
04	Camp 9, Block-C, Sub-Block-C12, Women Friendly Space (WFS), Ukhiya	Do	Latitude Value: 21.18856° N Longitude Value: 92.16173° E	13/02/2021	12.50 PM	WFS Area Block-C, Sub-Block-C-12	Local Stakeholders (DRP, Host & Union Parishad Representatives)	
05	Teknaf -Noyapara registered refugee camp, Block-H, Women Friendly Space (WFS), Teknaf	Teknaf Upazila in Cox's Bazar district	Latitude Value: 20.96139° N Longitude Value: 92.24792° E	13/02/2021	03.20 PM	WFS Area Block-H	Local Stakeholders (DRP, Host & Union Parishad Representatives)	
06	Camp-06, Block- D, Hill-11, Sub Block-C2, Women Friendly Space (WFS), Ukhiya	Ukhiya Upazila in Cox's Bazar district	Latitude Value: 21.20043° N Longitude Value: 92.15698° E	13/02/2021	10.20 AM	WFS Area Block-D, Sub-Block-C2	Local Stakeholders (DRP & Union Parishad Representatives)	

Annex-02: Pictures of Present Condition & location of 6 women friendly Space (WFS):



Camp 8W, Block-F, Women Friendly Space (WFS), Ukhiya



Camp 12, Block-G, Sub Block-G14, Women Friendly Space (WFS), Ukhiya



Camp 14, Block- A-2, Hakimpara, Friendly Space (WFS), Ukhiya



Camp 9, Block-C, Sub-Block-C12, Women Friendly Space (WFS), Ukhiya



Teknaf -Noyapara registered refugee camp, Block-H, Women Friendly Space (WFS), Teknaf



Camp-06, Block- D, Hill-11, Sub Block-C2, Women Friendly Space (WFS), Ukhiya

Annex-03: Social Screening of Camp 8W, Block-F, Women Friendly Space (WFS), Ukhiya.

Local Government Engineering Department (LGED)

Emergency Multi-Sector Rohingya Crisis Response Project (EMCRP)

Social Screening of Women Friendly Space (WFS), (Filled Form)

Section A: Sub-Project Overview

Description of sub-project/component interventions:

Proposed Women Friendly Space (WFS) is situated within the catchment area of Camp 8W, Block-F, union-Palongkhali, ward-01, Post-Balukhali of Ukhiya Upazila under Cox's Bazar District. Proposed WFS land is own by Government. The location has Child Care Space made of bamboo and tin. It is currently not in use as found during the survey. The location is spacious length wise but width is a bit narrow. WFS Structure plan will need adjustments This targeted Women Friendly Space (WFS) is inside DRP camp boundary.

The Sub-Project is categorized as single stored building with tin roof.

Details of the proposed Women Friendly Space (WFS) structure are given below:

SL #	WFS Facilities	Number	Length	Wide	Space (sq. ft.)
1	(a) Meeting room	1	24'-0"	16'-0"	384
	(b) Counseling room	1	11'-0"	9'-0"	99
	(c) Mid wife room	1	11'-0"	9'-0"	99
	(d) Office room	1	11'-0"	9'-0"	99
	(e) Corridor	1	45'-0"	4'-0"	180
2	Store room	1	12'-0"	7'-0"	84
3	Guard room	1	7'-0"	5'-0"	35
4	Generator room	1	7'-0"	6'-0"	42
5	PSS activities room	1	12'-0"	10'-0"	120
6	Latrine	1	5'-0"	5'-0"	25
7	Bath room	1	5'-0"	5'-0"	25
Total Space of Women Friendly Space (WFS) =					1192.00

The total area needed for these facilities is 1192.00 square feet. Moreover, the compound will be fenced with boundary made from wood and bamboo. There are abandoned child care spaces on the proposed location. It will need demolition in order to make space for the proposed Women Friendly space (WFS). Some cultural, archaeological, religious sites near (within 1km) of site are at north side Shelter (20m), Brac School (250m), Shelter (40m), at south side of Mosque (30m), Shelter (20m), Shelter (30m), at east side of Adolescent Center (10m), Shelter (30m), at the west site of Mosque (50m), Hefzokhana (30m), Madrassa (50m), Shelter (50m), SOS Children's Village International in Bangladesh School (70m). No scope to disturbance by this WFS which bring religious and cultural values to the community people. The people of the area will directly benefit from the implementation of the WFS which will contribute to the national development.

Sub-project Location:

Proposed Camp 8W, Block-F, Women Friendly Space (WFS) is categorized as a Rohingya Camp based WFS. The WFS area is situated in Palongkhali Union, Ward-1 under Ukhiya Upazila of Cox's Bazar district. The sub-project area is located at 21.19442° N and 92.15216° E. The distance from the Upazila headquarter is near about 9.0 km.

Important Features of Women Friendly Space (WFS) Location	
District	Cox's Bazar
Upazila	Ukhiya
Union	Palongkhali
WARD	01
Land Area Space	1725 sq. feet
Proposed WFS Structure Space	1192 sq. feet
Distance from Upazila Head quarter	09 Km
Camp 8W, Block-F, Women Friendly Space (WFS)	Latitude Value: 21.19442° N Longitude Value: 92.15216° E
Land ownership	Government

Expected construction period: 270 (Two hundred seventy) working days.

Description of project intervention area and project influence area with schematic diagram (where relevant, indicate distance to sensitive environmental areas such as elephant corridors, water bodies, etc. and historical or cultural assets): Please also explain any analysis on alternative location was conducted:

Answer: The proposed Camp 8W, Block-F, Women Friendly Space (WFS) have no located historical sites were found. There are not required to relocate local community. There are many socio-cultural assets in this proposed area but that will not be affected by the construction work. In consultation meeting it has revealed that no Elephants corridors there and no elephant has been found last few years in the proposed sub-project area. The proposed sub-project was finalized through effective consultation of DRP, local community, Local Government Representatives and Concerned LGED & Mukti Cox's Bazar officials.

Section B: Social Screening

Key Screening questions	Aspects to Consider
Will the project potentially involve an influx of workers to the project location, and will the influx be considered significant for the local community?	<p>✓ How many foreign and local workers will be needed for the remaining period of the WFS, with what skill set?</p> <p>Answer: There are available skilled and unskilled work forces in the WFS location. No foreign workers will be needed for the remaining of the project. If implementation authority has need then some skilled workforces may be hired from the outside. In construction work approximately 20 skilled and unskilled workforces are expected to be required for the construction work. Among them 05 will be skilled and 15 will be unskilled workforces.</p> <p>✓ Can the project hire workers from the local workforce?</p> <p>Answer: Definitely, all the unskilled labors will be engaged from DRP communities. Skilled labors will be hired from either locality or from the other place of Bangladesh.</p> <p>✓ What is the size and skill level of the existing local workforce?</p> <p>Answer: Based on consultation with local stakeholders, most of the workforces are available in the locality. If contractors need to hire some skilled workers from outside to the project area for implementing work as per contractors need.</p>

	<p>✓ If the skill level of the local workforce does not match the needs of the project, can they be trained within a reasonable timeframe to meet project requirements?</p> <p>Answer: Unskilled labor is available and some skilled in this area; So, If the skill level of the local workforce does not match the need of the WFS Construction, they can serve the purpose of skill labor as conducting skill training by the implementation authority within the time frame.</p> <p>✓ How will the workers be accommodated? Will they commute or reside on site or outside of the camp? If so, what size of camp will be required?</p> <p>Answer: Don't worry about for the local workers and their accommodation. Because an unskilled labor will be hired from DRP who are residing within the camp. The skilled labors are being accommodated on site of DRP camp by the implementation authority. Around 600 sq feet sized labor shed for 5 skilled labor.</p>
Is the WFS located in a rural or remote area?	<p>✓ What is the size of local population in the catchment area?</p> <p>Answer: There is no local population in the catchment area.</p> <p>✓ What is the size of the host Rohingya community in the catchment area?</p> <p>Answer: Camp 8W population are near about 30840. Approximately total household are 6621.</p> <p>WFS Catchment area targeted population are near about 6500. Approximately total household are 1240.</p> <p>✓ Is the project located / being carried out in an area that is not usually frequented by outsiders?</p> <p>Answer: Yes, local people are not allowed to visit camp without the permission of CIC.</p> <p>✓ What is the frequency and extent of contact between the local community and outsiders?</p> <p>Answer: From the observation, the frequency and extent of contact between the local community and outsiders Around 100 peoples use this WFS daily.</p> <p>✓ Are there sensitive environmental conditions that need to be considered?</p> <p>Answer: There are no sensitive environmental conditions in this area.</p>
Based on the socioeconomic, cultural, religious and demographic qualities of the local community, Rohingya population and the incoming workers, is there a possibility that their presence or interaction with the local community could create adverse impacts?	<p>✓ Is it likely that the incoming workers and the local community come from a shared socio-economic, cultural, religious or demographic background?</p> <p>Answer: No.</p> <p>✓ What is the level of existing resources, and will the incoming workers use or create competition for these resources?</p> <p>Answer: Incoming workers are very low in numbers, so there will be no competition in using of resources.</p> <p>✓ What is the expected duration of the incoming workers' presence in the community?</p> <p>Answer: The expected duration of the incoming workers duration is about 30 working days but it may be extended.</p> <p>✓ Given the characteristics of the local community, are there any specific adverse impacts that may be anticipated?</p> <p>Answer: No. Project will benefit the DRP.</p>
Consultation with Community People	<p>✓ Has the WFS authority and implementation authority conducted any consultation meetings with the community people and Rohingya population?</p> <p>Answer: The WFS authority and implementation authority conducted</p>

	<p>consultation several times with local community where their opinions have received with great honor. The implementing authority will conduct consultation meetings with the community people after finalization of contract.</p> <p>✓ Are local people aware about the labors?</p> <p>Answer: Yes. Local people are very much aware of local labors but they do not have any idea about outside labor forces.</p> <p>✓ Has the implementation authority involved the local community with the project?</p> <p>Answer: Yes, local communities are closely involved with this WFS. Several consultation meeting and informal interaction with local community have been conducted effectively.</p>
--	---

Section B.2. WFS acquisition and stakeholder screening

Probable Involuntary Resettlement Effects	Yes	No	Not Known	Remarks
Involuntary Acquisition of Land/ Land Donation/ Land Taking				
1. Will there be any land acquisition?		✓		No land acquisition will be required to Proposed WFS.
2. Is the site for land taking known?	✓			The land is selected with the recommendation of CIC and other project and construction concerned person and agencies.
3. Is the ownership status and current usage of land to be required temporary known?	✓			Land ownership is Government.
4. Will easement be utilized within an existing Right of Way (ROW)?	✓			In the camp area Provision is available be utilized within an existing Right of Way (ROW) within camp and WFS area.
5. Will there be loss of shelter and residential land due to land acquisition?		✓		N/A, no additional land will be required.
6. Will there be loss of agricultural and other productive assets due to land acquisition?		✓		No question of land acquisition. So, agricultural and other productive assets will not be damaged or lost by the construction of WFS.
7. Will there be losses of crops, trees, and fixed assets due to land acquisition?		✓		No standing crops, trees and fixed assets will be lost due to avoiding and minimize land acquisition.
8. Will there be loss of businesses or enterprises due to land acquisition?		✓		Land ownership is Government.
9. Will there be loss of income sources and means of livelihoods due to land acquisition?		✓		It is clearly revealed that income sources and means of livelihoods will not be hampered or lost by the activities of WFS.
Involuntary restrictions on land use or on access to legally designated parks and protected areas				
10. Will people lose access to natural resources, communal facilities and services?		✓		People access to communal facilities and services will not be hampered by the activities of WFS.
11. If land use is changed, will it have an adverse impact on social and economic activities?		✓		No scope to change site location.
12. Will access to land and resources owned communally or by the state be restricted?	✓			DRP camp & host community is demarked, restriction by the CIC, concern authority.

Information on Displaced Persons:
Any estimate of the likely number of persons that will be displaced by the Project? <input checked="" type="checkbox"/> No <input type="checkbox"/> Yes If yes, approximately how many? N/A
Are any of them poor, female-heads of households, or vulnerable to poverty risks? <input checked="" type="checkbox"/> No <input type="checkbox"/> Yes
Are any displaced persons from indigenous or ethnic minority groups? <input checked="" type="checkbox"/> No <input type="checkbox"/> Yes
During Screening, project authority will conduct consultation with the primary and secondary stakeholders and provide their observations in the following sections (13 to 18)
<p>13: Who are the stakeholders of the project?</p> <p>Answer:</p> <p>The key stakeholders from safeguards point of view include:</p> <p>Main stakeholders are DRP, host communities, Labors and</p> <ul style="list-style-type: none"> - Implementing agencies and their field staffs - People/communities directly affected by project activities - People/communities/organizations within the project influence area indirectly affected by project activities - Government departments/agencies -Development Partners - Local and international NGOs working with local host communities/DRP
<p>14: What social and cultural factors affect the ability of stakeholders to participate or benefit from the proposed policy or project?</p> <p>Answer: No such social and cultural factors, incidence exists to implement such development project in DRP camp areas that effect on the ability of stakeholders to participate or benefit from the proposed policy or project.</p>
<p>15: Are project objectives consistent with their needs, interests and capacity?</p> <p>Answer: Yes, the project objective is very much positive consistent with stakeholders needs interests identified by the community consultation and FGD.</p>
<p>16: What will be the impact of the project or sub-project on the various stakeholders, especially women and vulnerable groups?</p> <p>Answer: As a result of construction of WFS, the various stakeholders especially women and vulnerable groups will get easy access to Save the lives and Dignity of the women and girls from Rohingya communities and host community as well.</p>
<p>17: What social risks might affect project or sub-project success?</p> <p>Answer: As per the visit findings and consultation meeting with DRP community and other organizations representatives of in the scheme area, it has been revealed and perceived that the following some social risks might be affected sub-project success;</p> <ul style="list-style-type: none"> • Incoming labors may engage with anti-social activities which can challenge the values system of the society. • Noise and sound pollution may be generated in the locality. It also can hamper the study of the children as well as old ages during the construction period. • During the construction work, any kind of accident may occur.
<p>18: Has the project authority or any other organizations conducted any consultations with the affected community or people? If yes. Please provide a summary.</p> <p>Answer: The project authority has been conducted several consultations with the potential DRP community and Host people. During site selection UNFPA & Mukti, Cox's Bazar have been conducted several meetings with CIC officials, Site Management, service providers, DRP Community, local Union parishad representatives, and local governance representatives regarding the construction of WFS. During the screening, the consultant of Design and supervision consultant and PIU consultant of LGED also organized the consultation meetings and informed them about project objectives and other safeguard related issues. They also provided their feedback which are given below;</p> <p>01. The FGD results confirmed that decision of WFS construction will increase the sense of security of the communities.</p> <p>02. Providing psychosocial support to GBV and Non GBV survivors women and girls</p> <p>03. Case management of GBV survivors</p>

04. Provide Referral Services to the GBV and Non-GBV survivors women
05. Awareness Information Session in WFS
06. Awareness Information Session at outreach
07. Recreational activities for women and adolescents' girls
08. Develop and Disseminate IEC and BCC materials (Early marriage, puberty, HIV/AIDS, Hygiene etc.)
09. Form and functioning Women Support Group (WSG)
10. Community Watch Group formation and functioning (CWG)
11. Awareness raising session to reach women and girls with disabilities.
12. Distribution of Dignity Kits to the women and girls of re-productive age, Coordination meeting with other service providers for strengthening referral pathway for ensuring GBV and SRHR (Sexual & Reproductive Health & Rights) services.
13. COVID-19 awareness session & COVID-19 Kit distribution

Annex-04: Social Screening of Camp 12, Block-G, Sub Block-G14, Women Friendly Space (WFS), Ukhiya.
Local Government Engineering Department (LGED)
 Emergency Multi-Sector Rohingya Crisis Response Project (EMCRP)
 Social Screening of Women Friendly Space (WFS), (Filled Form)

Section A: Sub-Project Overview

Description of sub-project/component interventions:

Proposed Women Friendly Space (WFS) is situated within the catchment area of Camp 12, Block-G, Sub Block-G14, union- Palongkhali, ward-06, Post-Balukhali of Ukhiya Upazila under Cox's Bazar District. Proposed WFS land is own by Government. The location has Infant and young child feeding center of world vision made of bamboo and tin. It is currently not in use as found during the survey. The location has not enough space as it is currently but some earth cutting will be needed. The location is just on the toe of a hilly location but on the inclined surface. This targeted Women Friendly Space (WFS) is inside DRP camp boundary.

The Sub-Project is categorized as single stored building with tin roof.

Details of the proposed Women Friendly Space (WFS) structure are given below:

SL #	WFS Facilities	Number	Length	Wide	Space (sq. ft.)
1	(a) Meeting room	1	24'-0"	16'-0"	384
	(b) Counseling room	1	11'-0"	9'-0"	99
	(c) Mid wife room	1	11'-0"	9'-0"	99
	(d) Office room	1	11'-0"	9'-0"	99
	(e) Corridor	1	45'-0"	4'-0"	180
2	Store room	1	12'-0"	7'-0"	84
3	Guard room	1	7'-0"	5'-0"	35
4	Generator room	1	7'-0"	6'-0"	42
5	PSS activities room	1	12'-0"	10'-0"	120
6	Latrine	1	5'-0"	5'-0"	25
7	Bath room	1	5'-0"	5'-0"	25
Total Space of Women Friendly Space (WFS) =					1192.00

The total area needed for these facilities is 1192.00 square feet. Moreover, the compound will be fenced with boundary made from wood and bamboo. There are abandoned Mother and Baby Feeding Centre of UNICEF/World Vision on the proposed location. It will need demolition in order to make space for the proposed Women Friendly space (WFS). Some cultural, archaeological, religious sites near (within 1km) of site are at north side Mosque (100m), Dhaka Ahsania Mission School (150 NW), Graveyard (120m), DRP Settlements (80m), at south side of Mosque(15m), Mosque(50m), DAM School I(50m), DAM School J12 (100m), J13 (130m) J11 (150m), DRP Settlements (60m), at east side of Block F14 Mosque (70m), DRP Settlements (50m), at the west site of DRP Settlement Camp-19 (30m). No scope to disturbance by this WFS which bring religious and cultural values to the community people. The people of the area will directly benefit from the implementation of the WFS which will contribute to the national development.

Sub-project Location:

Proposed Camp 12, Block-G, Sub Block-G14, Women Friendly Space (WFS) is categorized as a Rohingya Camp based WFS. The WFS area is situated in Palongkhali Union, Ward-6, Post-Balukhali under Ukhiya Upazila of Cox's Bazar district. The sub-project area is located at 21.18208° N and 92.14819° E. The distance from the Upazila headquarter is near about 11.00 km.

Important Features of Women Friendly Space (WFS) Location	
District	Cox's Bazar
Upazila	Ukhiya
Union	Palongkhali
WARD	06
Post	Balukhali
Land Area Space	2236 sq. feet
Proposed WFS Structure Space	1192 sq. feet
Distance from Upazila Head quarter	11 Km
West Kutupalong Women Friendly Space (WFS)	Latitude Value: 21.18208° N Longitude Value: 92.14819° E
Land ownership	Government

Expected construction period: 270 (Two hundred seventy) working days.

Description of project intervention area and project influence area with schematic diagram (where relevant, indicate distance to sensitive environmental areas such as elephant corridors, water bodies, etc. and historical or cultural assets): Please also explain any analysis on alternative location was conducted:

Answer: The proposed Camp 12, Block-G, Sub Block-G14, Women Friendly Space (WFS) have no located historical sites were found. There are not required to relocate local community. There are many socio-cultural assets in this proposed area but that will not be affected by the construction work. In consultation meeting it has revealed that no Elephants corridors there and no elephant has been found last few years in the proposed sub-project area. The proposed sub-project was finalized through effective consultation of DRP, local community, Local Government Representatives and Concerned LGED & Mukti Cox's Bazar officials.

Section B: Social Screening

Key Screening questions	Aspects to Consider
Will the project potentially involve an influx of workers to the project location, and will the influx be considered significant for the local community?	<p>✓ How many foreign and local workers will be needed for the remaining period of the WFS, with what skill set?</p> <p>Answer: There are available skilled and unskilled work forces in the WFS location. No foreign workers will be needed for the remaining of the project. If implementation authority has need then some skilled workforces may be hired from the outside. In construction work approximately 20 skilled and unskilled workforces are expected to be required for the construction work. Among them 05 will be skilled and 15 will be unskilled workforces.</p> <p>✓ Can the project hire workers from the local workforce?</p> <p>Answer: Definitely, all the unskilled labors will be engaged from DRP communities. Skilled labors will be hired from either locality or from the other place of Bangladesh.</p> <p>✓ What is the size and skill level of the existing local workforce?</p> <p>Answer: Based on consultation with local stakeholders, most of the workforces are available in the locality. If contractors need to hire some skilled workers from outside to the project area for implementing work as per contractors need.</p>

	<p>✓ If the skill level of the local workforce does not match the needs of the project, can they be trained within a reasonable timeframe to meet project requirements?</p> <p>Answer: Unskilled labor is available and some skilled in this area; So, If the skill level of the local workforce does not match the need of the WFS Construction, they can serve the purpose of skill labor as conducting skill training by the implementation authority within the time frame.</p> <p>✓ How will the workers be accommodated? Will they commute or reside on site or outside of the camp? If so, what size of camp will be required?</p> <p>Answer: Don't worry about for the local workers and their accommodation. Because an unskilled labor will be hired from DRP who are residing within the camp. The skilled labors are being accommodated on site of DRP camp by the implementation authority. Around 600 sq feet sized labor shed for 5 skilled labor.</p>
Is the WFS located in a rural or remote area?	<p>✓ What is the size of local population in the catchment area?</p> <p>Answer: There is no local population in the catchment area.</p> <p>✓ What is the size of the host Rohingya community in the catchment area?</p> <p>Answer: Camp 12 population are near about 26182. Approximately total household are 5380.</p> <p>WFS Catchment area targeted population are near about 6500. Approximately total household are 1240.</p> <p>✓ Is the project located / being carried out in an area that is not usually frequented by outsiders?</p> <p>Answer: Yes, local people are not allowed to visit camp without the permission of CIC.</p> <p>✓ What is the frequency and extent of contact between the local community and outsiders?</p> <p>Answer: From the observation, the frequency and extent of contact between the local community and outsiders Around 100 peoples use this WFS daily.</p> <p>✓ Are there sensitive environmental conditions that need to be considered?</p> <p>Answer: There are no sensitive environmental conditions in this area.</p>
Based on the socioeconomic, cultural, religious and demographic qualities of the local community, Rohingya population and the incoming workers, is there a possibility that their presence or interaction with the local community could create adverse impacts?	<p>✓ Is it likely that the incoming workers and the local community come from a shared socio-economic, cultural, religious or demographic background?</p> <p>Answer: No.</p> <p>✓ What is the level of existing resources, and will the incoming workers use or create competition for these resources?</p> <p>Answer: Incoming workers are very low in numbers, so there will be no competition in using of resources.</p> <p>✓ What is the expected duration of the incoming workers' presence in the community?</p> <p>Answer: The expected duration of the incoming workers duration is about 30 working days but it may be extended.</p> <p>✓ Given the characteristics of the local community, are there any specific adverse impacts that may be anticipated?</p> <p>Answer: No. Project will benefit the DRP.</p>
Consultation with Community People	<p>✓ Has the WFS authority and implementation authority conducted any consultation meetings with the community people and Rohingya population?</p> <p>Answer: The WFS authority and implementation authority conducted</p>

	<p>consultation several times with local community where their opinions have received with great honor. The implementing authority will conduct consultation meetings with the community people after finalization of contract.</p> <p>✓ Are local people aware about the labors?</p> <p>Answer: Yes. Local people are very much aware of local labors but they do not have any idea about outside labor forces.</p> <p>✓ Has the implementation authority involved the local community with the project?</p> <p>Answer: Yes, local communities are closely involved with this WFS. Several consultation meeting and informal interaction with local community have been conducted effectively.</p>
--	---

Section B.2. WFS acquisition and stakeholder screening

Probable Effects	Involuntary	Resettlement	Yes	No	Not Known	Remarks
Involuntary Acquisition of Land/ Land Donation/ Land Taking						
1. Will there be any land acquisition?			✓			No land acquisition will be required to Proposed WFS.
2. Is the site for land taking known?	✓					The land is selected with the recommendation of CIC and other project and construction concerned person and agencies.
3. Is the ownership status and current usage of land to be required temporary known?	✓					Land ownership is Government.
4. Will easement be utilized within an existing Right of Way (ROW)?	✓					In the camp area Provision is available be utilized within an existing Right of Way (ROW) within camp and WFS area.
5. Will there be loss of shelter and residential land due to land acquisition?			✓			N/A, no additional land will be required.
6. Will there be loss of agricultural and other productive assets due to land acquisition?			✓			No question of land acquisition. So, agricultural and other productive assets will not be damaged or lost by the construction of WFS.
7. Will there be losses of crops, trees, and fixed assets due to land acquisition?			✓			No standing crops, trees and fixed assets will be lost due to avoiding and minimize land acquisition.
8. Will there be loss of businesses or enterprises due to land acquisition?			✓			Land ownership is Government.
9. Will there be loss of income sources and means of livelihoods due to land acquisition?			✓			It is clearly revealed that income sources and means of livelihoods will not be hampered or lost by the activities of WFS.
Involuntary restrictions on land use or on access to legally designated parks and protected areas						
10. Will people lose access to natural resources, communal facilities and services?			✓			People access to communal facilities and services will not be hampered by the activities of WFS.
11. If land use is changed, will it have an adverse impact on social and economic activities?			✓			No scope to change site location.
12. Will access to land and resources owned communally or by the state be restricted?	✓					DRP camp & host community is demarked, restriction by the CIC, concern authority.
Information on Displaced Persons:						

Any estimate of the likely number of persons that will be displaced by the Project? <input checked="" type="checkbox"/> No <input type="checkbox"/> Yes If yes, approximately how many? N/A
Are any of them poor, female-heads of households, or vulnerable to poverty risks? <input checked="" type="checkbox"/> No <input type="checkbox"/> Yes
Are any displaced persons from indigenous or ethnic minority groups? <input checked="" type="checkbox"/> No <input type="checkbox"/> Yes
During Screening, project authority will conduct consultation with the primary and secondary stakeholders and provide their observations in the following sections (13 to 18)
<p>13: Who are the stakeholders of the project?</p> <p>Answer:</p> <p>The key stakeholders from safeguards point of view include:</p> <p>Main stakeholders are DRP, host communities, Labors and</p> <ul style="list-style-type: none"> - Implementing agencies and their field staffs - People/communities directly affected by project activities - People/communities/organizations within the project influence area indirectly affected by project activities - Government departments/agencies -Development Partners - Local and international NGOs working with local host communities/DRP
<p>14: What social and cultural factors affect the ability of stakeholders to participate or benefit from the proposed policy or project?</p> <p>Answer: No such social and cultural factors, incidence exists to implement such development project in DRP camp areas that effect on the ability of stakeholders to participate or benefit from the proposed policy or project.</p>
<p>15: Are project objectives consistent with their needs, interests and capacity?</p> <p>Answer: Yes, the project objective is very much positive consistent with stakeholders needs interests identified by the community consultation and FGD.</p>
<p>16: What will be the impact of the project or sub-project on the various stakeholders, especially women and vulnerable groups?</p> <p>Answer: As a result of construction of WFS, the various stakeholders especially women and vulnerable groups will get easy access to Save the lives and Dignity of the women and girls from Rohingya communities and host community as well.</p>
<p>17: What social risks might affect project or sub-project success?</p> <p>Answer: As per the visit findings and consultation meeting with DRP community and other organizations representatives of in the scheme area, it has been revealed and perceived that the following some social risks might be affected sub-project success;</p> <ul style="list-style-type: none"> • Incoming labors may engage with anti-social activities which can challenge the values system of the society. • Noise and sound pollution may be generated in the locality. It also can hamper the study of the children as well as old ages during the construction period. • During the construction work, any kind of accident may occur.
<p>18: Has the project authority or any other organizations conducted any consultations with the affected community or people? If yes. Please provide a summary.</p> <p>Answer: The project authority has been conducted several consultations with the potential DRP community and Host people. During site selection UNFPA & Mukti, Cox's Bazar have been conducted several meetings with CIC officials, Site Management, service providers, DRP Community, local Union parishad representatives, and local governance representatives regarding the construction of WFS. During the screening, the consultant of Design and supervision consultant and PIU consultant of LGED also organized the consultation meetings and informed them about project objectives and other safeguard related issues. They also provided their feedback which are given below;</p> <p>01. The FGD results confirmed that decision of WFS construction will increase the sense of security of the communities.</p> <p>02. Providing psychosocial support to GBV and Non GBV survivors women and girls</p> <p>03. Case management of GBV survivors</p> <p>04. Provide Referral Services to the GBV and Non-GBV survivors women</p> <p>05. Awareness Information Session in WFS</p> <p>06. Awareness Information Session at outreach</p>

07. Recreational activities for women and adolescents' girls
08. Develop and Disseminate IEC and BCC materials (Early marriage, puberty, HIV/AIDS, Hygiene etc.)
09. Form and functioning Women Support Group (WSG)
10. Community Watch Group formation and functioning (CWG)
11. Awareness raising session to reach women and girls with disabilities.
12. Distribution of Dignity Kits to the women and girls of re-productive age, Coordination meeting with other service providers for strengthening referral pathway for ensuring GBV and SRHR (Sexual & Reproductive Health & Rights) services.
13. COVID-19 awareness session & COVID-19 Kit distribution

Annex-05: Social Screening of Camp 14, Block- A-2, Hakimpara, Friendly Space (WFS), Ukhiya.

Local Government Engineering Department (LGED)

Emergency Multi-Sector Rohingya Crisis Response Project (EMCRP)

Social Screening of Women Friendly Space (WFS), (Filled Form)

Section A: Sub-Project Overview

Description of sub-project/component interventions:

Proposed Women Friendly Space (WFS) is situated within the catchment area of Camp 14, Block- A-2, Hakipara, union- Palongkhali, ward-05, Post-Balukhali of Ukhiya Upazila under Cox's Bazar District. The location is an empty space but this is used as playground for children as found during the survey. The location has an earthen drain crossing in the middle and surrounded by U-drain as well. This location is a low-lying area which should consider water logging issues while designing. On behalf of Mukti Cox's Bazar, Mr. Bimal Chandra De Sarkar, Chief Executive officer, Sarda Bhaban, Goal Dighirpar, Cox's Bazar has rented the land of WFS from Mr. Siraj Miah, Father – Mr. Mozaher Miah, Village-Ghonar Para, Post- Balukhali, union- Palongkhali, Thana- Ukhiya, District-Cox's Bazar from 1st May 2021 to 31st December 2022. This rental agreement can be extended as required. This targeted Women Friendly Space (WFS) is inside DRP camp boundary.

The Sub-Project is categorized as single stored building with tin roof.

Details of the proposed Women Friendly Space (WFS) structure are given below:

SL #	WFS Facilities	Number	Length	Wide	Space (sq. ft.)
1	(a) Meeting room	2	24'-7"	16'-0"	786.56
	(b) Counseling room	1	11'-7"	9'-10"	113.83
	(c) Mid wife room	1	11'-7"	9'-7"	110.93
	(d) Office room	1	11'-7"	9'-10"	113.83
	(e) Corridor	1	63'-0"	5'-0"	315
2	Store room	1	12'-0"	7'-0"	84
3	Guard room	1	7'-0"	5'-0"	35
4	Generator room	1	7'-0"	6'-0"	42
5	PSS activities room	1	12'-0"	10'-0"	120
6	Latrine	2	5'-0"	5'-0"	50
7	Bath room	2	5'-0"	5'-0"	50
Total Space of Women Friendly Space (WFS) =					1821.15

The total area needed for these facilities is 1821.15 square feet. Moreover, the compound will be fenced with boundary made from wood and bamboo. The land is open space. Some cultural, archaeological, religious sites near (within 1km) of site are at north side Learning Center (10m), DRP Settlements (50m), at south side of Mosque (70m), Mosque (100m), DRP Settlements (60m), at east side of Pond (25m), Pond (25m), DRP Settlements (100m), at the west site of Mosque under Block A1 (20m), Mosque under Block A5 (120m). No scope to disturbance by this WFS which bring religious and cultural values to the community people. The people of the area will directly benefit from the implementation of the WFS which will contribute to the national development.

Sub-project Location:

Proposed Camp 14, Block- A-2, Hakimpara, Friendly Space (WFS) is categorized as a Rohingya Camp based WFS. The WFS area is situated in Palongkhali Union, Ward-5, Post-Balukhali under Ukhiya Upazila of Cox's Bazar district. The sub-project area is located at 21.16667° N and 92.14883° E. The distance from the Upazila headquarter is near about 18.00 km.

Important Features of Women Friendly Space (WFS) Location	
District	Cox's Bazar
Upazila	Ukhiya
Union	Palongkhali
WARD	05
Post	Balukhali
Land Area Space (Rented)	4000 sq. feet
Proposed WFS Structure Space	1821.15 sq. feet
Distance from Upazila Head quarter	18 Km
Camp 14, Block- A-2, Hakimpara, Friendly Space (WFS)	Latitude Value: 21.16667° N Longitude Value: 92.14883° E
Land ownership	Private Land (Rented)

Expected construction period: 270 (Two hundred seventy) working days.

Description of project intervention area and project influence area with schematic diagram (where relevant, indicate distance to sensitive environmental areas such as elephant corridors, water bodies, etc. and historical or cultural assets): Please also explain any analysis on alternative location was conducted:

Answer: The proposed Camp 14, Block- A-2, Hakimpara, Friendly Space (WFS) have no located historical sites were found. There are not required to relocate local community. There are many socio-cultural assets in this proposed area but that will not be affected by the construction work. In consultation meeting it has revealed that no Elephants corridors there and no elephant has been found last few years in the proposed sub-project area. The proposed sub-project was finalized through effective consultation of DRP, local community, Local Government Representatives and Concerned LGED & Mukti Cox's Bazar officials.

Section B: Social Screening

Key Screening questions	Aspects to Consider
Will the project potentially involve an influx of workers to the project location, and will the influx be considered significant for the local community?	<p>✓ How many foreign and local workers will be needed for the remaining period of the WFS, with what skill set?</p> <p>Answer: There are available skilled and unskilled work forces in the WFS location. No foreign workers will be needed for the remaining of the project. If implementation authority has need then some skilled workforces may be hired from the outside. In construction work approximately 20 skilled and unskilled workforces are expected to be required for the construction work. Among them 05 will be skilled and 15 will be unskilled workforces.</p> <p>✓ Can the project hire workers from the local workforce?</p> <p>Answer: Definitely, all the unskilled labors will be engaged from DRP communities. Skilled labors will be hired from either locality or from the other place of Bangladesh.</p> <p>✓ What is the size and skill level of the existing local workforce?</p> <p>Answer: Based on consultation with local stakeholders, most of the workforces are available in the locality. If contractors need to hire some skilled workers from outside to the project area for implementing work as per contractors need.</p>

	<p>✓ If the skill level of the local workforce does not match the needs of the project, can they be trained within a reasonable timeframe to meet project requirements?</p> <p>Answer: Unskilled labor is available and some skilled in this area; So, If the skill level of the local workforce does not match the need of the WFS Construction, they can serve the purpose of skill labor as conducting skill training by the implementation authority within the time frame.</p> <p>✓ How will the workers be accommodated? Will they commute or reside on site or outside of the camp? If so, what size of camp will be required?</p> <p>Answer: Don't worry about for the local workers and their accommodation. Because an unskilled labor will be hired from DRP who are residing within the camp. The skilled labors are being accommodated on site of DRP camp by the implementation authority. Around 600 sq feet sized labor shed for 5 skilled labor.</p>
Is the WFS located in a rural or remote area?	<p>✓ What is the size of local population in the catchment area?</p> <p>Answer: There is no local population in the catchment area.</p> <p>✓ What is the size of the host Rohingya community in the catchment area?</p> <p>Answer: Camp 14 population are near about 32608. Approximately total household are 6637.</p> <p>WFS Catchment area targeted population are near about 6500. Approximately total household are 1240.</p> <p>✓ Is the project located / being carried out in an area that is not usually frequented by outsiders?</p> <p>Answer: Yes, local people are not allowed to visit camp without the permission of CIC.</p> <p>✓ What is the frequency and extent of contact between the local community and outsiders?</p> <p>Answer: From the observation, the frequency and extent of contact between the local community and outsiders Around 100 peoples use this WFS daily.</p> <p>✓ Are there sensitive environmental conditions that need to be considered?</p> <p>Answer: There are no sensitive environmental conditions in this area.</p>
Based on the socioeconomic, cultural, religious and demographic qualities of the local community, Rohingya population and the incoming workers, is there a possibility that their presence or interaction with the local community could create adverse impacts?	<p>✓ Is it likely that the incoming workers and the local community come from a shared socio-economic, cultural, religious or demographic background?</p> <p>Answer: No.</p> <p>✓ What is the level of existing resources, and will the incoming workers use or create competition for these resources?</p> <p>Answer: Incoming workers are very low in numbers, so there will be no competition in using of resources.</p> <p>✓ What is the expected duration of the incoming workers' presence in the community?</p> <p>Answer: The expected duration of the incoming workers duration is about 30 working days but it may be extended.</p> <p>✓ Given the characteristics of the local community, are there any specific adverse impacts that may be anticipated?</p> <p>Answer: No. Project will benefit the DRP.</p>
Consultation with Community People	<p>✓ Has the WFS authority and implementation authority conducted any consultation meetings with the community people and Rohingya population?</p> <p>Answer: The WFS authority and implementation authority conducted</p>

	<p>consultation several times with local community where their opinions have received with great honor. The implementing authority will conduct consultation meetings with the community people after finalization of contract.</p> <p>✓ Are local people aware about the labors?</p> <p>Answer: Yes. Local people are very much aware of local labors but they do not have any idea about outside labor forces.</p> <p>✓ Has the implementation authority involved the local community with the project?</p> <p>Answer: Yes, local communities are closely involved with this WFS. Several consultation meeting and informal interaction with local community have been conducted effectively.</p>
--	---

Section B.2. WFS acquisition and stakeholder screening

Probable Involuntary Resettlement Effects	Yes	No	Not Known	Remarks
Involuntary Acquisition of Land/ Land Donation/ Land Taking				
1. Will there be any land acquisition?		✓		No land acquisition will be required to Proposed WFS.
2. Is the site for land taking known?	✓			The land is selected with the recommendation of CIC and other project and construction concerned person and agencies.
3. Is the ownership status and current usage of land to be required temporary known?	✓			Land ownership is Private (Rented).
4. Will easement be utilized within an existing Right of Way (ROW)?	✓			In the camp area Provision is available be utilized within an existing Right of Way (ROW) within camp and WFS area.
5. Will there be loss of shelter and residential land due to land acquisition?		✓		N/A, no additional land will be required.
6. Will there be loss of agricultural and other productive assets due to land acquisition?		✓		No question of land acquisition. So, agricultural and other productive assets will not be damaged or lost by the construction of WFS.
7. Will there be losses of crops, trees, and fixed assets due to land acquisition?		✓		No standing crops, trees and fixed assets will be lost due to avoiding and minimize land acquisition.
8. Will there be loss of businesses or enterprises due to land acquisition?		✓		Land ownership is Private (Rented).
9. Will there be loss of income sources and means of livelihoods due to land acquisition?		✓		It is clearly revealed that income sources and means of livelihoods will not be hampered or lost by the activities of WFS.
Involuntary restrictions on land use or on access to legally designated parks and protected areas				
10. Will people lose access to natural resources, communal facilities and services?		✓		People access to communal facilities and services will not be hampered by the activities of WFS.
11. If land use is changed, will it have an adverse impact on social and economic activities?		✓		No scope to change site location.
12. Will access to land and resources owned communally or by the state be restricted?	✓			DRP camp & host community is demarked, restriction by the CIC, concern authority.
Information on Displaced Persons:				

Any estimate of the likely number of persons that will be displaced by the Project? <input checked="" type="checkbox"/> No <input type="checkbox"/> Yes If yes, approximately how many? N/A
Are any of them poor, female-heads of households, or vulnerable to poverty risks? <input checked="" type="checkbox"/> No <input type="checkbox"/> Yes
Are any displaced persons from indigenous or ethnic minority groups? <input checked="" type="checkbox"/> No <input type="checkbox"/> Yes
During Screening, project authority will conduct consultation with the primary and secondary stakeholders and provide their observations in the following sections (13 to 18)
<p>13: Who are the stakeholders of the project?</p> <p>Answer:</p> <p>The key stakeholders from safeguards point of view include:</p> <p>Main stakeholders are DRP, host communities, Labors and</p> <ul style="list-style-type: none"> - Implementing agencies and their field staffs - People/communities directly affected by project activities - People/communities/organizations within the project influence area indirectly affected by project activities - Government departments/agencies -Development Partners - Local and international NGOs working with local host communities/DRP
<p>14: What social and cultural factors affect the ability of stakeholders to participate or benefit from the proposed policy or project?</p> <p>Answer: No such social and cultural factors, incidence exists to implement such development project in DRP camp areas that effect on the ability of stakeholders to participate or benefit from the proposed policy or project.</p>
<p>15: Are project objectives consistent with their needs, interests and capacity?</p> <p>Answer: Yes, the project objective is very much positive consistent with stakeholders needs interests identified by the community consultation and FGD.</p>
<p>16: What will be the impact of the project or sub-project on the various stakeholders, especially women and vulnerable groups?</p> <p>Answer: As a result of construction of WFS, the various stakeholders especially women and vulnerable groups will get easy access to Save the lives and Dignity of the women and girls from Rohingya communities and host community as well.</p>
<p>17: What social risks might affect project or sub-project success?</p> <p>Answer: As per the visit findings and consultation meeting with DRP community and other organizations representatives of in the scheme area, it has been revealed and perceived that the following some social risks might be affected sub-project success;</p> <ul style="list-style-type: none"> • Incoming labors may engage with anti-social activities which can challenge the values system of the society. • Noise and sound pollution may be generated in the locality. It also can hamper the study of the children as well as old ages during the construction period. • During the construction work, any kind of accident may occur.
<p>18: Has the project authority or any other organizations conducted any consultations with the affected community or people? If yes. Please provide a summary.</p> <p>Answer: The project authority has been conducted several consultations with the potential DRP community and Host people. During site selection UNFPA & Mukti, Cox's Bazar have been conducted several meetings with CIC officials, Site Management, service providers, DRP Community, local Union parishad representatives, and local governance representatives regarding the construction of WFS. During the screening, the consultant of Design and supervision consultant and PIU consultant of LGED also organized the consultation meetings and informed them about project objectives and other safeguard related issues. They also provided their feedback which are given below;</p> <p>01. The FGD results confirmed that decision of WFS construction will increase the sense of security of the communities.</p> <p>02. Providing psychosocial support to GBV and Non GBV survivors women and girls</p> <p>03. Case management of GBV survivors</p> <p>04. Provide Referral Services to the GBV and Non-GBV survivors women</p> <p>05. Awareness Information Session in WFS</p> <p>06. Awareness Information Session at outreach</p>

07. Recreational activities for women and adolescents' girls
08. Develop and Disseminate IEC and BCC materials (Early marriage, puberty, HIV/AIDS, Hygiene etc.)
09. Form and functioning Women Support Group (WSG)
10. Community Watch Group formation and functioning (CWG)
11. Awareness raising session to reach women and girls with disabilities.
12. Distribution of Dignity Kits to the women and girls of re-productive age, Coordination meeting with other service providers for strengthening referral pathway for ensuring GBV and SRHR (Sexual & Reproductive Health & Rights) services.
13. COVID-19 awareness session & COVID-19 Kit distribution

Annex-06: Social Screening of Camp 9, Block-C, Sub-Block-C12, Women Friendly Space (WFS), Ukhiya.

Local Government Engineering Department (LGED)

Emergency Multi-Sector Rohingya Crisis Response Project (EMCRP)

Social Screening of Women Friendly Space (WFS), (Filled Form)

Section A: Sub-Project Overview

Description of sub-project/component interventions:

Proposed Women Friendly Space (WFS) is situated within the catchment area of Camp 9, Block-C, Sub-Block-C12, union- Palongkhali, ward-01 of Ukhiya Upazila under Cox's Bazar District. The location is an open space which is currently used as playground for children. The location is an open space having a lot of settlements around. On behalf of Mukti Cox's Bazar, Mr. Bimal Chandra De Sarkar, Chief Executive officer, Sarda Bhaban, Goal Dighirpar, Cox's Bazar has rented the land of WFS from Mr. Shahab Uddin, Father - Late Abdul Latif Master, Village-Balukhali, Post- Balukhali, Thana- Ukhiya, District-Cox's Bazar from 1st May 2021 to 31st December 2022. This rental agreement can be extended as required. This targeted Women Friendly Space (WFS) is inside DRP camp boundary. The Sub-Project is categorized as single stored building with tin roof.

Details of the proposed Women Friendly Space (WFS) structure are given below:

SL #	WFS Facilities	Number	Length	Wide	Space (sq. ft.)
1	(a) Meeting room	2	24'-7"	16'-0"	786.56
	(b) Counseling room	1	11'-7"	9'-10"	113.83
	(c) Mid wife room	1	11'-7"	9'-7"	110.93
	(d) Office room	1	11'-7"	9'-10"	113.83
	(e) Corridor	1	63'-0"	5'-0"	315
2	Store room	1	12'-0"	7'-0"	84
3	Guard room	1	7'-0"	5'-0"	35
4	Generator room	1	7'-0"	6'-0"	42
5	PSS activities room	1	12'-0"	10'-0"	120
6	Latrine	2	5'-0"	5'-0"	50
7	Bath room	2	5'-0"	5'-0"	50
Total Space of Women Friendly Space (WFS) =					1821.15

The total area needed for these facilities is 1821.15 square feet. Moreover, the compound will be fenced with boundary made from wood and bamboo. At present proposed land of WFS is open space. Mukti Learning Center is located on the south side of the land. Some cultural, archaeological, religious sites near (within 1km) of site are at north side Mosque (250m), Host Settlements (30m), DRP Settlements (50m), Livestock shed (30m), at south side of Mosque (30m), Mosque (150m), Mosque (200m), Mosque (300m), Al-Belal Mosque (400m,) at east side of Mukti learning center (10m), Dhaka Ahsania Mission Learning center (50m), at the west site of Mosque (10m), Mukti learning center (350m), Brac learning center (400m), two wash blocks (15m). No scope to disturbance by this WFS which bring religious and cultural values to the community people. The people of the area will directly benefit from the implementation of the WFS which will contribute to the national development.

Sub-project Location:

Proposed Camp 9, Block-C, Sub-Block-C12, Women Friendly Space (WFS) is categorized as a Rohingya Camp based WFS. The WFS area is situated in Palongkhali Union, Ward-1, Post-Balukhali under Ukhiya Upazila of Cox's Bazar district. The sub-project area is located at 21.18856° N and 92.16173° E. The distance from the Upazila headquarter is near about 09.00 km.

Important Features of Women Friendly Space (WFS) Location	
District	Cox's Bazar
Upazila	Ukhiya
Union	Palongkhali
WARD	01
Land Area Space (Rented)	4000 sq. feet
Proposed WFS Structure Space	1821.15 sq. feet
Distance from Upazila Head quarter	09 Km
Camp 9, Block-C, Sub-Block-C12, Women Friendly Space (WFS)	Latitude Value: 21.18856° N Longitude Value: 92.16173° E
Land ownership	Private Land (Rented)

Expected construction period: 270 (Two hundred seventy) working days.

Description of project intervention area and project influence area with schematic diagram (where relevant, indicate distance to sensitive environmental areas such as elephant corridors, water bodies, etc. and historical or cultural assets): Please also explain any analysis on alternative location was conducted:

Answer: The proposed Camp 9, Block-C, Sub-Block-C12, Women Friendly Space (WFS) have no located historical sites were found. There are not required to relocate local community. There are many socio-cultural assets in this proposed area but that will not be affected by the construction work. In consultation meeting it has revealed that no Elephants corridors there and no elephant has been found last few years in the proposed sub-project area. The proposed sub-project was finalized through effective consultation of DRP, local community, Local Government Representatives and Concerned LGED & Mukti Cox's Bazar officials.

Section B: Social Screening

Key Screening questions	Aspects to Consider
Will the project potentially involve an influx of workers to the project location, and will the influx be considered significant for the local community?	<p>✓ How many foreign and local workers will be needed for the remaining period of the WFS, with what skill set?</p> <p>Answer: There are available skilled and unskilled work forces in the WFS location. No foreign workers will be needed for the remaining of the project. If implementation authority has need then some skilled workforces may be hired from the outside. In construction work approximately 20 skilled and unskilled workforces are expected to be required for the construction work. Among them 05 will be skilled and 15 will be unskilled workforces.</p> <p>✓ Can the project hire workers from the local workforce?</p> <p>Answer: Definitely, all the unskilled labors will be engaged from DRP communities. Skilled labors will be hired from either locality or from the other place of Bangladesh.</p> <p>✓ What is the size and skill level of the existing local workforce?</p> <p>Answer: Based on consultation with local stakeholders, most of the workforces are available in the locality. If contractors need to hire some skilled workers from outside to the project area for implementing work as per contractors need.</p> <p>✓ If the skill level of the local workforce does not match the needs of the project, can they be trained within a reasonable timeframe to meet project requirements?</p>

	<p>Answer: Unskilled labor is available and some skilled in this area; So, If the skill level of the local workforce does not match the need of the WFS Construction, they can serve the purpose of skill labor as conducting skill training by the implementation authority within the time frame.</p> <p>✓ How will the workers be accommodated? Will they commute or reside on site or outside of the camp? If so, what size of camp will be required?</p> <p>Answer: Don't worry about for the local workers and their accommodation. Because an unskilled labor will be hired from DRP who are residing within the camp. The skilled labors are being accommodated on site of DRP camp by the implementation authority. Around 600 sq feet sized labor shed for 5 skilled labor.</p>
Is the WFS located in a rural or remote area?	<p>✓ What is the size of local population in the catchment area?</p> <p>Answer: The sizes of Host (Local) population in the catchment area are near about 220. Approximately total household are 50.</p> <p>✓ What is the size of the host Rohingya community in the catchment area?</p> <p>Answer: Camp 19 population are near about 23743. Approximately total household are 4927.</p> <p>WFS Catchment area targeted population are near about 6500. Approximately total household are 1240.</p> <p>✓ Is the project located / being carried out in an area that is not usually frequented by outsiders?</p> <p>Answer: Yes, local people are not allowed to visit camp without the permission of CIC.</p> <p>✓ What is the frequency and extent of contact between the local community and outsiders?</p> <p>Answer: From the observation, the frequency and extent of contact between the local community and outsiders Around 100 peoples use this WFS daily.</p> <p>✓ Are there sensitive environmental conditions that need to be considered?</p> <p>Answer: There are no sensitive environmental conditions in this area.</p>
Based on the socioeconomic, cultural, religious and demographic qualities of the local community, Rohingya population and the incoming workers, is there a possibility that their presence or interaction with the local community could create adverse impacts?	<p>✓ Is it likely that the incoming workers and the local community come from a shared socio-economic, cultural, religious or demographic background?</p> <p>Answer: No.</p> <p>✓ What is the level of existing resources, and will the incoming workers use or create competition for these resources?</p> <p>Answer: Incoming workers are very low in numbers, so there will be no competition in using of resources.</p> <p>✓ What is the expected duration of the incoming workers' presence in the community?</p> <p>Answer: The expected duration of the incoming workers duration is about 30 working days but it may be extended.</p> <p>✓ Given the characteristics of the local community, are there any specific adverse impacts that may be anticipated?</p> <p>Answer: No. Project will benefit the DRP.</p>
Consultation with Community People	<p>✓ Has the WFS authority and implementation authority conducted any consultation meetings with the community people and Rohingya population?</p> <p>Answer: The WFS authority and implementation authority conducted consultation several times with local community where their opinions have received with great honor. The implementing authority will conduct</p>

	<p>consultation meetings with the community people after finalization of contract.</p> <p>✓ Are local people aware about the labors?</p> <p>Answer: Yes. Local people are very much aware of local labors but they do not have any idea about outside labor forces.</p> <p>✓ Has the implementation authority involved the local community with the project?</p> <p>Answer: Yes, local communities are closely involved with this WFS. Several consultation meeting and informal interaction with local community have been conducted effectively.</p>
--	--

Section B.2. WFS acquisition and stakeholder screening

Probable Involuntary Resettlement Effects	Yes	No	Not Known	Remarks
Involuntary Acquisition of Land/ Land Donation/ Land Taking				
1. Will there be any land acquisition?		✓		No land acquisition will be required to Proposed WFS.
2. Is the site for land taking known?	✓			The land is selected with the recommendation of CIC and other project and construction concerned person and agencies.
3. Is the ownership status and current usage of land to be required temporary known?	✓			Land ownership is Private (Rented).
4. Will easement be utilized within an existing Right of Way (ROW)?	✓			In the camp area Provision is available be utilized within an existing Right of Way (ROW) within camp and WFS area.
5. Will there be loss of shelter and residential land due to land acquisition?		✓		N/A, no additional land will be required.
6. Will there be loss of agricultural and other productive assets due to land acquisition?		✓		No question of land acquisition. So, agricultural and other productive assets will not be damaged or lost by the construction of WFS.
7. Will there be losses of crops, trees, and fixed assets due to land acquisition?		✓		No standing crops, trees and fixed assets will be lost due to avoiding and minimize land acquisition.
8. Will there be loss of businesses or enterprises due to land acquisition?		✓		Land ownership is Private (Rented).
9. Will there be loss of income sources and means of livelihoods due to land acquisition?		✓		It is clearly revealed that income sources and means of livelihoods will not be hampered or lost by the activities of WFS.
Involuntary restrictions on land use or on access to legally designated parks and protected areas				
10. Will people lose access to natural resources, communal facilities and services?		✓		People access to communal facilities and services will not be hampered by the activities of WFS.
11. If land use is changed, will it have an adverse impact on social and economic activities?		✓		No scope to change site location.
12. Will access to land and resources owned communally or by the state be restricted?	✓			DRP camp & host community is demarked, restriction by the CIC, concern authority.
Information on Displaced Persons:				
Any estimate of the likely number of persons that will be displaced by the Project? [✓] No [] Yes If yes, approximately how many? N/A				

Are any of them poor, female-heads of households, or vulnerable to poverty risks? <input checked="" type="checkbox"/> No <input type="checkbox"/> Yes
Are any displaced persons from indigenous or ethnic minority groups? <input checked="" type="checkbox"/> No <input type="checkbox"/> Yes
During Screening, project authority will conduct consultation with the primary and secondary stakeholders and provide their observations in the following sections (13 to 18)
<p>13: Who are the stakeholders of the project?</p> <p>Answer:</p> <p>The key stakeholders from safeguards point of view include:</p> <p>Main stakeholders are DRP, host communities, Labors and</p> <ul style="list-style-type: none"> - Implementing agencies and their field staffs - People/communities directly affected by project activities - People/communities/organizations within the project influence area indirectly affected by project activities - Government departments/agencies -Development Partners - Local and international NGOs working with local host communities/DRP
<p>14: What social and cultural factors affect the ability of stakeholders to participate or benefit from the proposed policy or project?</p> <p>Answer: No such social and cultural factors, incidence exists to implement such development project in DRP camp areas that effect on the ability of stakeholders to participate or benefit from the proposed policy or project.</p>
<p>15: Are project objectives consistent with their needs, interests and capacity?</p> <p>Answer: Yes, the project objective is very much positive consistent with stakeholders needs interests identified by the community consultation and FGD.</p>
<p>16: What will be the impact of the project or sub-project on the various stakeholders, especially women and vulnerable groups?</p> <p>Answer: As a result of construction of WFS, the various stakeholders especially women and vulnerable groups will get easy access to Save the lives and Dignity of the women and girls from Rohingya communities and host community as well.</p>
<p>17: What social risks might affect project or sub-project success?</p> <p>Answer: As per the visit findings and consultation meeting with DRP community and other organizations representatives of in the scheme area, it has been revealed and perceived that the following some social risks might be affected sub-project success;</p> <ul style="list-style-type: none"> • Incoming labors may engage with anti-social activities which can challenge the values system of the society. • Noise and sound pollution may be generated in the locality. It also can hamper the study of the children as well as old ages during the construction period. • During the construction work, any kind of accident may occur.
<p>18: Has the project authority or any other organizations conducted any consultations with the affected community or people? If yes. Please provide a summary.</p> <p>Answer: The project authority has been conducted several consultations with the potential DRP community and Host people. During site selection UNFPA & Mukti, Cox's Bazar have been conducted several meetings with CIC officials, Site Management, service providers, DRP Community, local Union parishad representatives, and local governance representatives regarding the construction of WFS. During the screening, the consultant of Design and supervision consultant and PIU consultant of LGED also organized the consultation meetings and informed them about project objectives and other safeguard related issues. They also provided their feedback which are given below;</p> <p>01. The FGD results confirmed that decision of WFS construction will increase the sense of security of the communities.</p> <p>02. Providing psychosocial support to GBV and Non GBV survivors women and girls</p> <p>03. Case management of GBV survivors</p> <p>04. Provide Referral Services to the GBV and Non-GBV survivors women</p> <p>05. Awareness Information Session in WFS</p> <p>06. Awareness Information Session at outreach</p>

07. Recreational activities for women and adolescents' girls
08. Develop and Disseminate IEC and BCC materials (Early marriage, puberty, HIV/AIDS, Hygiene etc.)
09. Form and functioning Women Support Group (WSG)
10. Community Watch Group formation and functioning (CWG)
11. Awareness raising session to reach women and girls with disabilities.
12. Distribution of Dignity Kits to the women and girls of re-productive age, Coordination meeting with other service providers for strengthening referral pathway for ensuring GBV and SRHR (Sexual & Reproductive Health & Rights) services.
13. COVID-19 awareness session & COVID-19 Kit distribution.

Annex-07: Social Screening of Teknaf -Nayapara registered refugee camp, Block-H, Women Friendly Space (WFS), Teknaf.

Local Government Engineering Department (LGED)

Emergency Multi-Sector Rohingya Crisis Response Project (EMCRP)

Social Screening of Women Friendly Space (WFS), (Filled Form)

Section A: Sub-Project Overview

Description of sub-project/component interventions:

Proposed Women Friendly Space (WFS) is situated within the catchment area of Teknaf -Nayapara registered refugee camp, Block-H, union- Nhila, Post-South Nhila, ward-08 of Teknaf Upazila under Cox's Bazar District. On behalf of Mukti Cox's Bazar, Mr. Bimal Chandra De Sarkar, Chief Executive officer, Sarda Bhaban, Goal Dighirpar, Cox's Bazar has rented the land of WFS from Mr. Nabi Hossain, Father - Late Sultan Ahmed, Mother-Fatema Khatun, Village-Leda (West Para), Post- Rangikhali, Thana- Nhila, District-Cox's Bazar from 1st May 2021 to 31st December 2022. This rental agreement can be extended as required. This targeted Women Friendly Space (WFS) is inside DRP camp boundary. The Sub-Project is categorized as single stored building with tin roof.

Details of the proposed Women Friendly Space (WFS) structure are given below:

SL #	WFS Facilities	Number	Length	Wide	Space (sq. ft.)
1	(a) Meeting room	2	24'-7"	16'-0"	786.56
	(b) Counseling room	1	11'-7"	9'-10"	113.83
	(c) Mid wife room	1	11'-7"	9'-7"	110.93
	(d) Office room	1	11'-7"	9'-10"	113.83
	(e) Corridor	1	63'-0"	5'-0"	315
2	Store room	1	12'-0"	7'-0"	84
3	Guard room	1	7'-0"	5'-0"	35
4	Generator room	1	7'-0"	6'-0"	42
5	PSS activities room	1	12'-0"	10'-0"	120
6	Latrine	2	5'-0"	5'-0"	50
7	Bath room	2	5'-0"	5'-0"	50
Total Space of Women Friendly Space (WFS) =					1821.15

The total area needed for these facilities is 1821.15 square feet. Moreover, the compound will be fenced with boundary made from wood and bamboo. At present proposed land of WFS is open space. Some cultural, archaeological, religious sites near (within 1km) of site are at north side Rohingya Bazar (20m), Graveyard of Block-i (300m), DRP Settlements (70m), at south side of Mosque (70m), Mosque (80m SW), Mosque (200m), School (10m), DRP Settlements (50m), at east side of Mosque (30m), BDR Camp (15m), Host households (50m), DRP settlements (70m), at the west site of Mosque (50m), School (70m), Mosque (70m), Ansar/BGB Mosque (50m), Graveyard (500m). No scope to disturbance by this WFS which bring religious and cultural values to the community people. The people of the area will directly benefit from the implementation of the WFS which will contribute to the national development.

Sub-project Location:

Proposed Teknaf -Nayapara registered refugee camp, Block-H, Women Friendly Space (WFS) is categorized as a Rohingya Camp based WFS. The WFS area is situated in Nhila Union, Ward-8, Post-South Nhila under Teknaf Upazila of Cox's Bazar district. The sub-project area is located at 20.96139° N and 92.24792° E. The distance from the Upazila headquarter is near about 12.00 km.

Important Features of Women Friendly Space (WFS) Location	
District	Cox's Bazar
Upazila	Teknaf
Union	Nhila
WARD	08
Post	South Nhila
Land Area Space (Rented)	2800 sq. feet
Proposed WFS Structure Space	1821.15 sq. feet
Distance from Upazila Head quarter	12 Km
Teknaf -Nayapara registered refugee camp, Block-H, Women Friendly Space (WFS)	Latitude Value: 20.96139° N Longitude Value: 92.24792° E
Land ownership	Private Land (Rented)

Expected construction period: 270 (Two hundred seventy) working days.

Description of project intervention area and project influence area with schematic diagram (where relevant, indicate distance to sensitive environmental areas such as elephant corridors, water bodies, etc. and historical or cultural assets): Please also explain any analysis on alternative location was conducted:

Answer: The proposed Teknaf -Nayapara registered refugee camp, Block-H, Women Friendly Space (WFS) have no located historical sites were found. There are not required to relocate local community. There are many socio-cultural assets in this proposed area but that will not be affected by the construction work. In consultation meeting it has revealed that no Elephants corridors there and no elephant has been found last few years in the proposed sub-project area. The proposed sub-project was finalized through effective consultation of DRP, local community, Local Government Representatives and Concerned LGED & Mukti Cox's Bazar officials.

Section B: Social Screening

Key Screening questions	Aspects to Consider
Will the project potentially involve an influx of workers to the project location, and will the influx be considered significant for the local community?	<p>✓ How many foreign and local workers will be needed for the remaining period of the WFS, with what skill set?</p> <p>Answer: There are available skilled and unskilled work forces in the WFS location. No foreign workers will be needed for the remaining of the project. If implementation authority has need then some skilled workforces may be hired from the outside. In construction work approximately 20 skilled and unskilled workforces are expected to be required for the construction work. Among them 05 will be skilled and 15 will be unskilled workforces.</p> <p>✓ Can the project hire workers from the local workforce?</p> <p>Answer: Definitely, all the unskilled labors will be engaged from DRP communities. Skilled labors will be hired from either locality or from the other place of Bangladesh.</p> <p>✓ What is the size and skill level of the existing local workforce?</p> <p>Answer: Based on consultation with local stakeholders, most of the workforces are available in the locality. If contractors need to hire some skilled workers from outside to the project area for implementing work as per contractors need.</p>

	<p>✓ If the skill level of the local workforce does not match the needs of the project, can they be trained within a reasonable timeframe to meet project requirements?</p> <p>Answer: Unskilled labor is available and some skilled in this area; So, If the skill level of the local workforce does not match the need of the WFS Construction, they can serve the purpose of skill labor as conducting skill training by the implementation authority within the time frame.</p> <p>✓ How will the workers be accommodated? Will they commute or reside on site or outside of the camp? If so, what size of camp will be required?</p> <p>Answer: Don't worry about for the local workers and their accommodation. Because an unskilled labor will be hired from DRP who are residing within the camp. The skilled labors are being accommodated on site of DRP camp by the implementation authority. Around 600 sq feet sized labor shed for 5 skilled labor.</p>
Is the WFS located in a rural or remote area?	<p>✓ What is the size of local population in the catchment area?</p> <p>Answer: The sizes of Host (Local) population in the catchment area are near about 2358. Approximately total household are 450.</p> <p>✓ What is the size of the host Rohingya community in the catchment area?</p> <p>Answer: Nayapara RC Registered Camp population are near about 22582. Approximately total household are 4304.</p> <p>WFS Catchment area targeted population are near about 6500. Approximately total household are 1240.</p> <p>✓ Is the project located / being carried out in an area that is not usually frequented by outsiders?</p> <p>Answer: Yes, local people are not allowed to visit camp without the permission of CIC.</p> <p>✓ What is the frequency and extent of contact between the local community and outsiders?</p> <p>Answer: From the observation, the frequency and extent of contact between the local community and outsiders Around 100 peoples use this WFS daily.</p> <p>✓ Are there sensitive environmental conditions that need to be considered?</p> <p>Answer: There are no sensitive environmental conditions in this area.</p>
Based on the socioeconomic, cultural, religious and demographic qualities of the local community, Rohingya population and the incoming workers, is there a possibility that their presence or interaction with the local community could create adverse impacts?	<p>✓ Is it likely that the incoming workers and the local community come from a shared socio-economic, cultural, religious or demographic background?</p> <p>Answer: No.</p> <p>✓ What is the level of existing resources, and will the incoming workers use or create competition for these resources?</p> <p>Answer: Incoming workers are very low in numbers, so there will be no competition in using of resources.</p> <p>✓ What is the expected duration of the incoming workers' presence in the community?</p> <p>Answer: The expected duration of the incoming workers duration is about 30 working days but it may be extended.</p> <p>✓ Given the characteristics of the local community, are there any specific adverse impacts that may be anticipated?</p> <p>Answer: No. Project will benefit the DRP.</p>
Consultation with Community People	<p>✓ Has the WFS authority and implementation authority conducted any consultation meetings with the community people and Rohingya population?</p>

	<p>Answer: The WFS authority and implementation authority conducted consultation several times with local community where their opinions have received with great honor. The implementing authority will conduct consultation meetings with the community people after finalization of contract.</p> <p>✓ Are local people aware about the labors?</p> <p>Answer: Yes. Local people are very much aware of local labors but they do not have any idea about outside labor forces.</p> <p>✓ Has the implementation authority involved the local community with the project?</p> <p>Answer: Yes, local communities are closely involved with this WFS. Several consultation meeting and informal interaction with local community have been conducted effectively.</p>
--	---

Section B.2. WFS acquisition and stakeholder screening

Probable Involuntary Resettlement Effects	Yes	No	Not Known	Remarks
Involuntary Acquisition of Land/ Land Donation/ Land Taking				
1. Will there be any land acquisition?		✓		No land acquisition will be required to Proposed WFS.
2. Is the site for land taking known?	✓			The land is selected with the recommendation of CIC and other project and construction concerned person and agencies.
3. Is the ownership status and current usage of land to be required temporary known?	✓			Land ownership is Private (Rented).
4. Will easement be utilized within an existing Right of Way (ROW)?	✓			In the camp area Provision is available be utilized within an existing Right of Way (ROW) within camp and WFS area.
5. Will there be loss of shelter and residential land due to land acquisition?		✓		N/A, no additional land will be required.
6. Will there be loss of agricultural and other productive assets due to land acquisition?		✓		No question of land acquisition. So, agricultural and other productive assets will not be damaged or lost by the construction of WFS.
7. Will there be losses of crops, trees, and fixed assets due to land acquisition?		✓		No standing crops, trees and fixed assets will be lost due to avoiding and minimize land acquisition.
8. Will there be loss of businesses or enterprises due to land acquisition?		✓		Land ownership is Private (Rented).
9. Will there be loss of income sources and means of livelihoods due to land acquisition?		✓		It is clearly revealed that income sources and means of livelihoods will not be hampered or lost by the activities of WFS.
Involuntary restrictions on land use or on access to legally designated parks and protected areas				
10. Will people lose access to natural resources, communal facilities and services?		✓		People access to communal facilities and services will not be hampered by the activities of WFS.
11. If land use is changed, will it have an adverse impact on social and economic activities?		✓		No scope to change site location.
12. Will access to land and resources owned communally or by the state be restricted?	✓			DRP camp & host community is demarked, restriction by the CIC, concern authority.

Information on Displaced Persons:
Any estimate of the likely number of persons that will be displaced by the Project? <input checked="" type="checkbox"/> No <input type="checkbox"/> Yes If yes, approximately how many? N/A
Are any of them poor, female-heads of households, or vulnerable to poverty risks? <input checked="" type="checkbox"/> No <input type="checkbox"/> Yes
Are any displaced persons from indigenous or ethnic minority groups? <input checked="" type="checkbox"/> No <input type="checkbox"/> Yes
During Screening, project authority will conduct consultation with the primary and secondary stakeholders and provide their observations in the following sections (13 to 18)
<p>13: Who are the stakeholders of the project?</p> <p>Answer:</p> <p>The key stakeholders from safeguards point of view include:</p> <p>Main stakeholders are DRP, host communities, Labors and</p> <ul style="list-style-type: none"> - Implementing agencies and their field staffs - People/communities directly affected by project activities - People/communities/organizations within the project influence area indirectly affected by project activities - Government departments/agencies -Development Partners - Local and international NGOs working with local host communities/DRP
<p>14: What social and cultural factors affect the ability of stakeholders to participate or benefit from the proposed policy or project?</p> <p>Answer: No such social and cultural factors, incidence exists to implement such development project in DRP camp areas that effect on the ability of stakeholders to participate or benefit from the proposed policy or project.</p>
<p>15: Are project objectives consistent with their needs, interests and capacity?</p> <p>Answer: Yes, the project objective is very much positive consistent with stakeholders needs interests identified by the community consultation and FGD.</p>
<p>16: What will be the impact of the project or sub-project on the various stakeholders, especially women and vulnerable groups?</p> <p>Answer: As a result of construction of WFS, the various stakeholders especially women and vulnerable groups will get easy access to Save the lives and Dignity of the women and girls from Rohingya communities and host community as well.</p>
<p>17: What social risks might affect project or sub-project success?</p> <p>Answer: As per the visit findings and consultation meeting with DRP community and other organizations representatives of in the scheme area, it has been revealed and perceived that the following some social risks might be affected sub-project success;</p> <ul style="list-style-type: none"> • Incoming labors may engage with anti-social activities which can challenge the values system of the society. • Noise and sound pollution may be generated in the locality. It also can hamper the study of the children as well as old ages during the construction period. • During the construction work, any kind of accident may occur.
<p>18: Has the project authority or any other organizations conducted any consultations with the affected community or people? If yes. Please provide a summary.</p> <p>Answer: The project authority has been conducted several consultations with the potential DRP community and Host people. During site selection UNFPA & Mukti, Cox's Bazar have been conducted several meetings with CIC officials, Site Management, service providers, DRP Community, local Union parishad representatives, and local governance representatives regarding the construction of WFS. During the screening, the consultant of Design and supervision consultant and PIU consultant of LGED also organized the consultation meetings and informed them about project objectives and other safeguard related issues. They also provided their feedback which are given below;</p> <p>01. The FGD results confirmed that decision of WFS construction will increase the sense of security of the communities.</p> <p>02. Providing psychosocial support to GBV and Non GBV survivors women and girls</p> <p>03. Case management of GBV survivors</p>

04. Provide Referral Services to the GBV and Non-GBV survivors women
05. Awareness Information Session in WFS
06. Awareness Information Session at outreach
07. Recreational activities for women and adolescents' girls
08. Develop and Disseminate IEC and BCC materials (Early marriage, puberty, HIV/AIDS, Hygiene etc.)
09. Form and functioning Women Support Group (WSG)
10. Community Watch Group formation and functioning (CWG)
11. Awareness raising session to reach women and girls with disabilities.
12. Distribution of Dignity Kits to the women and girls of re-productive age, Coordination meeting with other service providers for strengthening referral pathway for ensuring GBV and SRHR (Sexual & Reproductive Health & Rights) services.
13. COVID-19 awareness session & COVID-19 Kit distribution.

Annex-08: Social Screening of Camp-06, Block- D, Hill-11, Sub Block-C2, Women Friendly Space (WFS), Ukhiya.

Local Government Engineering Department (LGED)

Emergency Multi-Sector Rohingya Crisis Response Project (EMCRP)

Social Screening of Women Friendly Space (WFS), (Filled Form)

Section A: Sub-Project Overview

Description of sub-project/component interventions:

Proposed Women Friendly Space (WFS) is situated within the catchment area of Camp-06, Block- D, Hill-11, Sub Block-C2 in Rajapalong union, ward-09 of Ukhiya Upazila under Cox's Bazar District. The Proposed WFS location has an existing facility called Women & Girl Safe space moderated by International Rescue Committee (IRC). This location has pre-established rooms for all the facility needed for WFS This targeted Women Friendly Space (WFS) is inside DRP Community. The Sub-Project is categorized as bamboo made structure tin roof house for delivering WFS facilities. It already houses one Meeting room, three Counselling Room, one Mid-Wife Room, one Toilet, one adolescence care room, Corridor etc. The total area of existing facility is 780 square feet. Moreover, the compound does not need separate fencing because existing boundary exists. Although, if deemed necessary extra fencing can be placed on the back side of the proposed location as the current condition was found to have weak tarpaulin fencing. Some cultural, archaeological, religious sites near (within 1km) of site are at north side of Mosque (400m), DRP Settlements (50m), at south side Mosque (50m), Mosque (250m), learning center (20m), DRP Settlements (40m), at east side of Brac learning center (20m), DRP Settlements (50m), Chora (60m), at the west site of Mosque (100m), Brac learning center (400m), Plan learning center (400m), DRP Settlements (10m), Concrete made drain (5m). No scope to disturbance by this WFS which bring religious and cultural values to the community people. The people of the area will directly benefit from the implementation of the WFS which will contribute to the national development.

Sub-project Location:

Proposed Camp-06, Block- D, Hill-11, Sub Block-C2, Women Friendly Space (WFS) is categorized as a Rohingya Camp based WFS. The WFS area is situated in Palongkhali Union, Ward-9, Post-Balukhali under Ukhiya Upazila of Cox's Bazar district. The sub-project area is located at 21.20043° N and 92.15698° E. The distance from the Upazila headquarter is near about 09.00 km.

Important Features of Women Friendly Space (WFS) Location	
District	Cox's Bazar
Upazila	Ukhiya
Union	Palongkhali
WARD	09
Land Area Space	1050 sq. feet
WFS Structure Space (Present Situation)	780 sq. feet
Distance from Upazila Head quarter	09 Km

Camp-06, Block- D, Hill-11, Sub Block-C2, Women Friendly Space (WFS)	Latitude Value: 21.20043° N Longitude Value: 92.15698° E
Land ownership	Government

Expected construction period: Not Applicable.

Description of project intervention area and project influence area with schematic diagram (where relevant, indicate distance to sensitive environmental areas such as elephant corridors, water bodies, etc. and historical or cultural assets): Please also explain any analysis on alternative location was conducted:

Answer: The proposed Camp-06, Block- D, Hill-11, Sub Block-C2, Women Friendly Space (WFS) have no located historical sites were found. There are not required to relocate local community. There are many socio-cultural assets in this proposed area but that will not be affected by the construction work. In consultation meeting it has revealed that no Elephants corridors there and no elephant has been found last few years in the proposed sub-project area. The proposed sub-project was finalized through effective consultation of DRP, local community, Local Government Representatives and Concerned LGED & Mukti Cox's Bazar officials.

Section B: Social Screening

Key Screening questions	Aspects to Consider
Will the project potentially involve an influx of workers to the project location, and will the influx be considered significant for the local community?	<p>✓ How many foreign and local workers will be needed for the remaining period of the WFS, with what skill set? Answer: Not Applicable.</p> <p>✓ Can the project hire workers from the local workforce? Answer: Not Applicable.</p> <p>✓ What is the size and skill level of the existing local workforce? Answer: Not Applicable.</p> <p>✓ If the skill level of the local workforce does not match the needs of the project, can they be trained within a reasonable timeframe to meet project requirements? Answer: Not Applicable.</p> <p>✓ How will the workers be accommodated? Will they commute or reside on site or outside of the camp? If so, what size of camp will be required? Answer: Not Applicable.</p>
Is the WFS located in a rural or remote area?	<p>✓ What is the size of local population in the catchment area? Answer: There is no local population in the catchment area.</p> <p>✓ What is the size of the host Rohingya community in the catchment area? Answer: Camp-06 population are near about 23224. Approximately total household are 4912. WFS Catchment area targeted population are near about 6500. Approximately total household are 1240.</p> <p>✓ Is the project located / being carried out in an area that is not usually frequented by outsiders? Answer: Yes, local people are not allowed to visit camp without the permission of CIC.</p> <p>✓ What is the frequency and extent of contact between the local community and outsiders? Answer: From the observation, the frequency and extent of contact between the local community and outsiders Around 100 peoples use this WFS daily.</p> <p>✓ Are there sensitive environmental conditions that need to be considered? Answer: There are no sensitive environmental conditions in this area.</p>

Based on the socioeconomic, cultural, religious and demographic qualities of the local community, Rohingya population and the incoming workers, is there a possibility that their presence or interaction with the local community could create adverse impacts?	<p>✓ Is it likely that the incoming workers and the local community come from a shared socio-economic, cultural, religious or demographic background? Answer: Not Applicable.</p> <p>✓ What is the level of existing resources, and will the incoming workers use or create competition for these resources? Answer: Not Applicable.</p> <p>✓ What is the expected duration of the incoming workers' presence in the community? Answer: Not Applicable.</p> <p>✓ Given the characteristics of the local community, are there any specific adverse impacts that may be anticipated? Answer: No. Project will benefit the DRP.</p>
Consultation with Community People	<p>✓ Has the WFS authority and implementation authority conducted any consultation meetings with the community people and Rohingya population? Answer: The WFS authority and implementation authority conducted consultation several times with local community where their opinions have received with great honor. The implementing authority will conduct consultation meetings with the community people after finalization of contract.</p> <p>✓ Are local people aware about the labors? Answer: Not Applicable.</p> <p>✓ Has the implementation authority involved the local community with the project? Answer: Yes, local communities are closely involved with this WFS. Several consultation meeting and informal interaction with local community have been conducted effectively.</p>

Section B.2. WFS acquisition and stakeholder screening

Probable Involuntary Resettlement Effects	Yes	No	Not Known	Remarks
Involuntary Acquisition of Land/ Land Donation/ Land Taking				
1. Will there be any land acquisition?		✓		No land acquisition will be required to Proposed WFS.
2. Is the site for land taking known?	✓			The land is selected with the recommendation of CIC and other project and construction concerned person and agencies.
3. Is the ownership status and current usage of land to be required temporary known?	✓			Land ownership is Government.
4. Will easement be utilized within an existing Right of Way (ROW)?	✓			In the camp area Provision is available be utilized within an existing Right of Way (ROW) within camp and WFS area.
5. Will there be loss of shelter and residential land due to land acquisition?		✓		N/A, no additional land will be required.
6. Will there be loss of agricultural and other productive assets due to land acquisition?		✓		No question of land acquisition. So, agricultural and other productive assets will not be damaged or lost by the construction of WFS.
7. Will there be losses of crops, trees, and fixed assets due to land acquisition?		✓		No standing crops, trees and fixed assets will be lost due to avoiding and minimize land acquisition.
8. Will there be loss of businesses or		✓		Land ownership is Government.

enterprises due to land acquisition?				
9. Will there be loss of income sources and means of livelihoods due to land acquisition?		√		It is clearly revealed that income sources and means of livelihoods will not be hampered or lost by the activities of WFS.
Involuntary restrictions on land use or on access to legally designated parks and protected areas				
10. Will people lose access to natural resources, communal facilities and services?		√		People access to communal facilities and services will not be hampered by the activities of WFS.
11. If land use is changed, will it have an adverse impact on social and economic activities?		√		No scope to change site location.
12. Will access to land and resources owned communally or by the state be restricted?	√			DRP camp & host community is demarked, restriction by the CIC, concern authority.
Information on Displaced Persons:				
Any estimate of the likely number of persons that will be displaced by the Project? [√] No [] Yes If yes, approximately how many? N/A				
Are any of them poor, female-heads of households, or vulnerable to poverty risks? [√] No [] Yes				
Are any displaced persons from indigenous or ethnic minority groups? [√] No [] Yes				
During Screening, project authority will conduct consultation with the primary and secondary stakeholders and provide their observations in the following sections (13 to 18)				
13: Who are the stakeholders of the project? Answer: The key stakeholders from safeguards point of view include: Main stakeholders are DRP, host communities, Labors and - Implementing agencies and their field staffs - People/communities directly affected by project activities - People/communities/organizations within the project influence area indirectly affected by project activities - Government departments/agencies -Development Partners - Local and international NGOs working with local host communities/DRP				
14: What social and cultural factors affect the ability of stakeholders to participate or benefit from the proposed policy or project? Answer: No such social and cultural factors, incidence exists to implement such development project in DRP camp areas that effect on the ability of stakeholders to participate or benefit from the proposed policy or project.				
15: Are project objectives consistent with their needs, interests and capacity? Answer: Yes, the project objective is very much positive consistent with stakeholders needs interests identified by the community consultation and FGD.				
16: What will be the impact of the project or sub-project on the various stakeholders, especially women and vulnerable groups? Answer: As a result of construction of WFS, the various stakeholders especially women and vulnerable groups will get easy access to Save the lives and Dignity of the women and girls from Rohingya communities and host community as well.				
17: What social risks might affect project or sub-project success? Answer: As per the visit findings and consultation meeting with DRP community and other organizations representatives of in the scheme area, it has been revealed and perceived that the following some social risks might be affected sub-project success; <ul style="list-style-type: none"> • Incoming labors may engage with anti-social activities which can challenge the values system of the society. • Noise and sound pollution may be generated in the locality. It also can hamper the study of the children as well as old ages during the construction period. 				

- During the construction work, any kind of accident may occur.

18: Has the project authority or any other organizations conducted any consultations with the affected community or people? If yes. Please provide a summary.

Answer: The project authority has been conducted several consultations with the potential DRP community and Host people. During site selection UNFPA & Mukti, Cox's Bazar have been conducted several meetings with CIC officials, Site Management, service providers, DRP Community, local Union parishad representatives, and local governance representatives regarding the construction of WFS. During the screening, the consultant of Design and supervision consultant and PIU consultant of LGED also organized the consultation meetings and informed them about project objectives and other safeguard related issues. They also provided their feedback which are given below;

01. The FGD results confirmed that decision of WFS construction will increase the sense of security of the communities.
02. Providing psychosocial support to GBV and Non GBV survivors women and girls
03. Case management of GBV survivors
04. Provide Referral Services to the GBV and Non-GBV survivors women
05. Awareness Information Session in WFS
06. Awareness Information Session at outreach
07. Recreational activities for women and adolescents' girls
08. Develop and Disseminate IEC and BCC materials (Early marriage, puberty, HIV/AIDS, Hygiene etc.)
09. Form and functioning Women Support Group (WSG)
10. Community Watch Group formation and functioning (CWG)
11. Awareness raising session to reach women and girls with disabilities.
12. Distribution of Dignity Kits to the women and girls of re-productive age, Coordination meeting with other service providers for strengthening referral pathway for ensuring GBV and SRHR (Sexual & Reproductive Health & Rights) services.
13. COVID-19 awareness session & COVID-19 Kit distribution.

Annex-09: Screening Findings and Mitigation Measures

Mitigation measures need to be proposed in referenced to ESMP Guidelines relevant to the type of the sub-project, proposed in Section 8.3 of ESMF. Accordingly, we have completed the task followed by FGD and public consultation for the sub projects. Those are given below;

Section	Main Environmental and Social Impacts	Impact Significance*	Suggested Mitigation Measures	Person/Institution Responsible	Monitoring Suggestions	
					Indicators	Frequency
1: Sub-Project Interventions	There are 6 (Six) WFS will be established in DRP camp as well as necessary agreements & acknowledgement are attached in Annex: 18-31					
2: Pre-improvement Phase	Loss of land/and other physical assets	No adverse impact will be generated	<ul style="list-style-type: none">No land acquisition will be required for 6 WFS in DRP areas in rented private land.As all 6 (six) WFS will be established on rented empty private land or existing well equipped building structure, therefore no required to replace any temporary structures/assets to other place.No Households will be affected by the intervention of sub-projects. If we found any grievance from the neighboring habitants, we will consult on emergency basis in order to solve the problem by project GRC.	PIU consultant, PSC and D&SC	<ul style="list-style-type: none">✓ Number of Complaints✓ Check Grievance register✓ Resolutions against the grievances	Ensure regular supervision and Monitoring based on compliance.
	Loss of livelihood	No impact may be generated	<ul style="list-style-type: none">No significant impact will be generated by the subproject but due to Rohingya influx, job opportunities may be reduced. Local people particularly women laborers shall get priority with equal payment at the time of labor recruitment.Code of conduct required for the local labours as well as Rohingya labours.During construction work, social safeguard compliance will be maintained properly by the contractor.	PIU consultant, PSC and D&SC	<ul style="list-style-type: none">✓ Labor wages payroll✓ Interview with labour✓ Frequent visit by D&SC and PIU personnel✓ Copy of code of conduct	Weekly basis

	Site Selection & implementing interventions: Human-elephant conflict	No adverse impact may be generated	<ul style="list-style-type: none"> Selection of sub-project sites and all implementing interventions must take place outside of the elephant corridor/influence area. 	PIU consultant, PSC and D&SC	<ul style="list-style-type: none"> ✓ Check sub-project Map ✓ Checking IUCN report ✓ Documents check and an Interview of Elephants response team 	Monthly basis
	Loss of right to access	No adverse impact will be generated	<ul style="list-style-type: none"> In case of unavoidable circumstances, alternative access will be provided. 	PIU consultant, PSC and D&SC	<ul style="list-style-type: none"> ✓ Physical verification ✓ Picture of alternative way 	Monthly basis
	Avoidance and minimize socially sensitive area	No adverse impact will be generated	<ul style="list-style-type: none"> Social, cultural and religious institution like; Educational institution, Mosque, temple, archeological structure shall take care of carefully for avoiding or minimizing physical fractures and esthetical values. 	Construction Contractor	<ul style="list-style-type: none"> ✓ Visit to socially sensitive area ✓ Interaction with local community 	Monthly basis
3: Construction Phase	Traffic Accidents	Low impact may be generated	<ul style="list-style-type: none"> ✓ Clear construction area markings. ✓ Recording and reporting of accident incidents to local police station Annual reporting of accident figures to PSC 	Construction Contractor and Monitored by Consultant of PIU and D&SC	<ul style="list-style-type: none"> ✓ No. of accident took place ✓ Marking and signage of road ✓ Record of police station and PSC 	Monthly basis

*Overall Impact Score: **High** = Likely to cause long-term E&S impacts; **Medium** = Likely to cause temporary impacts; **Low** = Likely to cause little, short-term impacts

Annex-10: At a Glance Public Consultation of 6 sub-projects (WFS)

1. Project Stakeholders:

DRP Camp, host community (especially female), surrounding villages peoples, implementing agencies and their agencies, labors, local elected representative, local administration, DPHE, LGED, DoE, BFD, UNFPA Development partners and local and international NGOs working with DRP camp etc.

2. Methodology:

Adoption of appropriate methodology plays a very crucial role to prepare the social screening of subprojects. Participatory process has been followed to conduct social screening. Participatory public consultation has been conducted at each and every sub-project level with the participants of host and DRP camp female and local elected representatives. There are some PRA tools that are used for collecting data such as; FGD, key informant interviews, social screening form (SSF). In public consultation meetings that are held at sub-projects level, project beneficiaries and stakeholders have been properly informed about project related information. In addition, effective mitigation measures have also been reflected in SMP in SL. # 15.

3. Feedback, Suggestions and recommendations of the participants:

The following feedback, suggestions and recommendations came out from the participants: -

- The FGD results confirmed that decision of WFS construction will increase the sense of security of the communities.
- To be provided psychosocial support to GBV and Non GBV survivors women and girls
- Case management of GBV survivors
- Suggested to Provide Referral Services to the GBV and Non-GBV survivors women
- To be conducted Awareness Information Session in WFS
- To be conducted Awareness Information Session at outreach
- Recreational activities for women and adolescents' girls socially and culturally shall be accepted.
- Suggested to Develop and Disseminate IEC and BCC materials (Early marriage, puberty, HIV/AIDS, Hygiene etc.)
- Formation and functioning Women Support Group (WSG) should be ensured.
- Community Watch Group formation and functioning (CWG) should be ensured.
- Awareness rising session to reach women and girls with disabilities should be ensured.
- Distribution of Dignity Kits to the women and girls of re-productive age, Coordination meeting with other service providers for strengthening referral pathway for ensuring GBV and SRHR (Sexual & Reproductive Health & Rights) services would be started at the beginning stage
- COVID-19 awareness session & COVID-19 Kit distribution would be started with necessary training/orientation and to emphasis safety issue carefully during COVID-19.

4. Conclusion:

In conclusion, it can be clearly revealed that all selected places where WFS will be constructed and established is very good in terms of geographical features, easy communication, law and order situation, safety & security both for DRP and Host communities' women and girls. Local people love to call WFS as "Shantikhana" for women and girls; therefore, selection of place for WFS is well perfect in the local context of Ukhya and Teknaf Upazila under Cox's Bazar district. Gender based violence (GBV) is seeing one of the biggest problems to the women and adolescent girls. These WFS is expected to mobilize the local destitute women and girls and scope to educate them with different issues. So, they can tackle the situation by taking effective steps as against any sorts of discrimination and humiliation. Besides, these 57 platforms will allow them to interact with fellow women and girls on contemporary local societal issues in relation to women and girls and will able them to mitigate those issues through collective initiatives. Therefore, establishment and functioning of WFS is expected to bring tremendous socio-economic and cultural benefit for the women and girls of selected WFS catchment area.

Annex-11: Photographs of Consultation Meeting with Stakeholders of 6 (Six) WFS.



Camp 8W, Block-F, Women Friendly Space (WFS), Ukhiya



Camp 12, Block-G, Sub Block-G14, Women Friendly Space (WFS), Ukhiya



Camp 14, Block- A-2, Hakimpara, Friendly Space (WFS), Ukhiya



Camp 9, Block-C, Sub-Block-C12, Women Friendly Space (WFS), Ukhiya



Teknaf -Noyapara registered refugee camp, Block-H, Women Friendly Space (WFS), Teknaf



Camp-06, Block- D, Hill-11, Sub Block-C2, Women Friendly Space (WFS), Ukhiya

Annex-12 to 17: List of Participants Attended in a Consultation Meeting of 6 WFS.

Camp 12, Block-G, Sub Block-G14, Women Friendly Space (WFS), Ukhiya

Emergency Multi-Sector Rohingya Crisis Response Project (EMCRP)

স্বরাষ্ট্র মন্ত্রণালয় (স্বরাষ্ট্র) (স্বরাষ্ট্র) (স্বরাষ্ট্র) (স্বরাষ্ট্র)

Local Government Engineering Department (LGED)

Public Consultation Participants List

Focus Group Discussion

সময়: 12:40 PM

তারিখ: 11.02.21

উপস্থাপক/আয়োজক: WFS - Camp-12 Block-G, Sub-Block-14

স্থান: House of Hafiz Majhi, Camp 12, Block-G, Sub-Block-14

সংগঠন: Polongkhali বাড়ি নং: 06 অঞ্চল: Bolukhali উপজেলা: Ukhiya জেলা: ককচড়া

সময়: 12:40 PM

আয়োজক/আয়োজক (নাম ও পদ)

ক্রম নং	নাম	বয়স	পুরুষ/মহিলা	জন্ম	স্বাক্ষর / উপস্থিতি
১	আব্দুল হক (মহিলা)	৪০	মহিলা	Camp-12	আব্দুল হক
২	আব্দুল হক (মহিলা)	২৫	মহিলা	মহিলা	আব্দুল হক
৩	আব্দুল হক (মহিলা)	৫৬	মহিলা	মহিলা	আব্দুল হক
৪	আব্দুল হক (মহিলা)	২০	মহিলা	মহিলা	আব্দুল হক
৫	আব্দুল হক (মহিলা)	৬৭	মহিলা	মহিলা	আব্দুল হক
৬	আব্দুল হক (মহিলা)	৪০	মহিলা	মহিলা	আব্দুল হক
৭	আব্দুল হক (মহিলা)	৬৬	মহিলা	মহিলা	আব্দুল হক
৮	আব্দুল হক (মহিলা)	৪০	মহিলা	মহিলা	আব্দুল হক
৯	আব্দুল হক (মহিলা)	২৫	মহিলা	মহিলা	আব্দুল হক
১০	আব্দুল হক (মহিলা)	৫০	মহিলা	মহিলা	আব্দুল হক

Camp 14, Block- A-2, Hakimpara, Friendly Space (WFS), Ukhiya

Safeguard Screening of Women Friendly Space

Public Consultation Participants List

Focus Group Discussion

ସମୟ: 08:00 PM

ତାରିଖ: 11.02.2024

ଠିକଣା/ସ୍ଥାନ: WFS - Camp-14 - Block-A-2

ସଂଗଠନ: House of Sakin Mazhi, Camp-14, Block-A-2

ପଞ୍ଚାୟତ: Bobongkhali ପର୍ଯ୍ୟାୟ: 05 ଅଞ୍ଚଳ: Bobongkhali ଗ୍ରାମ: Ukhiya ଜିଲ୍ଲା: ଖୋର୍ଦ୍ଧା

ସମସ୍ତଙ୍କୁ ସ୍ୱାଗତ କରାଯାଉଛି।

ସାମ୍ବାଦନାମାଲିପିର ସଂକଳିତ (ନାମ ଓ ବୟସ)

କ୍ରମ ନଂ	ନାମ	ବୟସ	ପୁରୁଷ/ମହିଳା	ଠିକଣା	ସ୍ୱାକ୍ଷର / ଚିହ୍ନ
1	ସୁମିତ୍ରା ମାଝି	40	ମହିଳା	Camp-14	ସୁମିତ୍ରା
2	ସୁମିତ୍ରା ମାଝି	40	ମ	୫	ସୁମିତ୍ରା
3	ସୁମିତ୍ରା	22	ମ	୫	ସୁମିତ୍ରା
4	ସୁମିତ୍ରା ମାଝି	38	ମ	୫	ସୁମିତ୍ରା
5	ସୁମିତ୍ରା ମାଝି	38	ମ	୫	ସୁମିତ୍ରା
6	ସୁମିତ୍ରା ମାଝି	40	ମ	୫	ସୁମିତ୍ରା
7	ସୁମିତ୍ରା ମାଝି	40	ମ	୫	ସୁମିତ୍ରା
8	ସୁମିତ୍ରା ମାଝି	40	ମ	୫	ସୁମିତ୍ରା
9	ସୁମିତ୍ରା ମାଝି	40	ମ	୫	ସୁମିତ୍ରା
10	ସୁମିତ୍ରା ମାଝି	40	ମ	୫	ସୁମିତ୍ରା

**Teknaf -Noyapara registered refugee camp, Block-H,
Women Friendly Space (WFS), Teknaf**

Safeguard Screening of Women Friendly Space

Public Consultation Participants List

Focus Group Discussion

তারিখ: ০৩.১০.২০

তারিখ: ১৯.০১.২১

স্থান: WFS - Registered Camp - Block - H.

স্থান: Regi. Camp, Block - H, Sunflower Model Primary School.

কক্ষ: Huila

তারিখ: ০৪

সময়:

স্থান: Teknaf

সময়: সকাল

সংগঠন:

সংগঠনগত তথ্য (পরিচয় ও বয়স)

ক্র.সং.	নাম	বয়স	পেশা/শিক্ষা	সং.	স্বাক্ষর/চিহ্ন
১	জিয়া মল্লিক	৬০	মহিলা	Reg. Camp Block-H	জিয়া মল্লিক
২	জিয়া	৩৫	"	"	জিয়া
৩	জিয়া মল্লিক	৩০	"	"	জিয়া মল্লিক
৪	জিয়া মল্লিক	৪০	"	"	জিয়া
৫	জিয়া মল্লিক	৩৫	"	"	জিয়া
৬	জিয়া মল্লিক	৩০	"	"	জিয়া
৭	জিয়া মল্লিক	৪৫	"	"	জিয়া
৮	জিয়া মল্লিক	৪০	"	"	জিয়া
৯	জিয়া মল্লিক	৪০	"	"	জিয়া
১০	জিয়া মল্লিক	৪০	"	"	জিয়া
১১	জিয়া মল্লিক	৪০	"	"	জিয়া
১২	জিয়া মল্লিক	৪০	"	"	জিয়া
১৩	জিয়া মল্লিক	৪০	"	"	জিয়া
১৪	জিয়া মল্লিক	৪০	"	"	জিয়া
১৫	জিয়া মল্লিক	৪০	"	"	জিয়া
১৬	জিয়া মল্লিক	৪০	"	"	জিয়া
১৭	জিয়া মল্লিক	৪০	"	"	জিয়া
১৮	জিয়া মল্লিক	৪০	"	"	জিয়া
১৯	জিয়া মল্লিক	৪০	"	"	জিয়া
২০	জিয়া মল্লিক	৪০	"	"	জিয়া

Camp-06, Block- D, Hill-11, Sub Block-C2, Women Friendly Space (WFS), Ukhiya

Safeguard Screening of Women Friendly Space

Public Consultation Participants List

Focus Group Discussion

TIME: 10:20 AM

संवि० : १५.०५.७६

39-6807 (MCM) at 17A - WFS Camp - 06, Block - D, Sub Block - C2

we focus on Camp-06, Block-D, SubBlock-c2 Girls & Women Safe Space

REGION: Bayanlari DISTRICT: 09 NAME: Baluphali SEX: Ukhiya DATE: 10/01/2020

www.pearsoned.com.au

आन्ध्रप्रदेश राज्य (भारत में एक राज्य)

क्र.सं.	विषय	समय	पुस्तक/पेपर	समय	समय / दिनांक
१	भाषाशास्त्र	७०	सर्वा	Comp-16	
२	भाषाशास्त्र	२३	h	h	
३	संस्कृतभाषा	२४	h	h	
४	संस्कृतभाषा	२०	h	h	०५
५	संस्कृतभाषा	७०	h	h	०५
६	संस्कृतभाषा	२४	h	h	२०म२१०
७	संस्कृतभाषा	२५	h	h	
८	संस्कृतभाषा	७०	h	h	५०म२१०

Annex-18 to 31: List of Land/House Agreement & Acknowledgement of 6 WFS.

Camp 8W, Block-F, Women Friendly Space (WFS), Ukhiya



Mukti Cox's Bazar

*A peaceful Universal Society Free From Poverty and Prejudice
Where People will Live in Dignity and Security.*

স্বাক্ষর নং: মুক্তি কক্সবাজার/জিবিডি/২০২২/৬৬

১৫ই আগস্ট ২০২২ ইং

বরাবর,
ক্যাম্প ইনচার্জ।
ক্যাম্প নং- 8W,
বালুখালি, উখিয়া, কক্সবাজার।

বিষয়: মুক্তি কক্সবাজার কর্তৃক পরিচালিত “Providing Quality GBV Prevention and Response for the Rohingya and Host Communities in Cox's Bazar to increase Community wellbeing” প্রকল্পের অধিনে রোহিঙ্গা শরণার্থী নারী ও কিশোরীদের জন্য নারী বান্ধব সেবা কেন্দ্র (WFS) এর মাধ্যমে সেবা প্রদানের অনুমোদন প্রসঙ্গে।

জনাব,

মুক্তি কক্সবাজার এর পক্ষ থেকে আন্তরিক শুভেচ্ছা।

জাতিসংঘ জনসংখ্যা তহবিল (UNFPA) এর আর্থিক সহায়তায় মুক্তি কক্সবাজার কর্তৃক ২০১৭ সাল থেকে “Providing Quality GBV Prevention and Response for the Rohingya and Host Communities in Cox's Bazar to increase Community wellbeing” প্রকল্পের অধিনে, উখিয়া ও টেকনাফ উপজেলার বিভিন্ন শরণার্থী ক্যাম্পে ১৯ টি এবং হোস্ট কমিউনিটিতে ৪টি নারী বান্ধব সেবা (WFS) কেন্দ্র পরিচালনা করে আসছে। নারী বান্ধব সেবা কেন্দ্র (WFS) এর মাধ্যমে মিয়ানমারের রাখাইন রাজ্য হতে কলপ্রয়োগে বাধ্যকৃত মিয়ানমার নাগরিক রোহিঙ্গা এবং স্থানীয় নারী ও কিশোরীদের মনো-সামাজিক সেবা প্রদান, রেফারেল সেবা প্রদান, কাউন্সিলিং সেবা প্রদান, মিডওয়াইফারি সেবা প্রদান, ডিগনিটি কিট বিতরণ (নারী ও কিশোরীদের) এবং ওয়াশ সাপোর্ট প্রদান কার্যক্রম বাস্তবায়ন করে আসছে। উক্ত কার্যক্রমের মাধ্যমে আরো বেশি নারী ও কিশোরীদের সেবা প্রদানের জন্য ক্যাম্প 8W তে নারী বান্ধব সেবা কেন্দ্র (WFS) এর মাধ্যমে উক্ত সেবা প্রদান করতে ইচ্ছুক।

অতএব আপনার নিকট নিবেদন এই যে, ক্যাম্প- 8W তে একটি নারী বান্ধব সেবা কেন্দ্র (WFS) স্থাপনের মাধ্যমে রোহিঙ্গা নারী ও কিশোরীদের মনো-সামাজিক সেবা প্রদান, রেফারেল সেবা প্রদান, কাউন্সিলিং সেবা প্রদান, মিডওয়াইফারি সেবা প্রদান, ডিগনিটি কিট বিতরণ (নারী ও কিশোরীদের) এবং ওয়াশ সাপোর্ট প্রদান কার্যক্রম পরিচালনার জন্য বিশেষ ভাবে অনুমতি কামনা করছি।

ধন্যবাদান্তে



মো: শামীম সরদার
কর্মসূচী ব্যবস্থাপক (GBViE) প্রকল্প
মুক্তি কক্সবাজার।
মোব: ০১৭১২-৯৪৫-৩২১

Received
১৫/০৮/২০২২
Community Mobilizer
RRRC
Camp-8W
Ukhiya, Cox's Bazar.



HEAD OFFICE: SARADA BHABAN, GOLDIGHIR PAR, COX'S BAZAR, BANGLADESH.
Tel : 88-0341-62558, Fax: 0341-51103, E-mail: mukticox@gmail.com, Web: www.muktibd.org



Mukti Cox's Bazar

*A peaceful Universal Society Free From Poverty and Prejudice
Where People will Live in Dignity and Security.*

স্মারক নং-মুক্তি কক্সবাজার/জিবিটি/২০২২/৪২

জেজুয়ারী ০৮, ২০২১ ইং

স্বাক্ষর,
ক্যাম্প ইনচার্জ।
ক্যাম্প নং- ১২,
উখিয়া, কক্সবাজার।

বিষয়: মুক্তি কক্সবাজার কর্তৃক পরিচালিত "Providing Quality GBV Prevention and Response for the Rohingya and Host Communities in Cox's Bazar to increase Community wellbeing" প্রকল্পের অধীনে একটি নারী বাসব সেবা কেন্দ্র (WFS) স্থাপনের মাধ্যমে রোহিঙ্গা নারী ও কিশোরীদের সেবা প্রদানের অনুমোদন প্রসঙ্গে।

জন্মাব,

মুক্তি কক্সবাজার এর পক্ষ থেকে আন্তরিক তত্তেজ্ঞা।

জাতিসংঘ জনসংখ্যা তহবিল (UNFPA) এর কারিগরী সহায়তায় মুক্তি কক্সবাজার কর্তৃক ২০১৭ সাল থেকে "Providing Quality GBV Prevention and Response for the Rohingya and Host Communities in Cox's Bazar to increase Community wellbeing" প্রকল্পের অধীনে, উখিয়া ও টেকনাফ উপজেলার বিভিন্ন শরণার্থী ক্যাম্পে ১৯ টি নারী বাসব সেবা কেন্দ্র (WFS) এর মাধ্যমে মিয়ানমারের রাখাইন রাজ্য হতে বলপ্রয়োগে বাধ্যতায় মিয়ানমার নাগরিক রোহিঙ্গা নারী ও কিশোরীদের মনো-সামাজিক সেবা প্রদান, রেফারেল সেবা প্রদান, কাউন্সিলিং সেবা প্রদান, মিডওয়াইফারি সেবা প্রদান, ডিগনিটি কিট বিতরণ এবং ওয়াশ সাপোর্ট প্রদান কার্যক্রম বাস্তবায়ন করে আসছে। বর্তমানে বিশ্ব ব্যাংক ও এলজিইডি এর অর্থায়নে Emergency Multi-Sector Rohingya Crisis Response Project এর Loan/Credit/Grant No.: Grant Number-D419-BD, Loan/Credit/Grant Closing Date: March 5, 2022, Reference No.EMCRP/GBV/S2 এর আওতায় স্থানীয় এবং রোহিঙ্গা নারী ও কিশোরীদের উক্ত সেবা প্রদানের জন্য বিভিন্ন ক্যাম্পে নতুন একাধিক নারী বাসব সেবা কেন্দ্র স্থাপন করা হবে। এরই ধারাবাহিকতায় ক্যাম্প ১২ তে একটি নতুন নারী বাসব সেবা কেন্দ্র (WFS) স্থাপনের মাধ্যমে সেবা প্রদান করতে ইচ্ছুক।

অতএব আপনার নিকট নিবেদন এই যে, ক্যাম্প- ১২ তে নতুন একটি নারী বাসব সেবা কেন্দ্র (WFS) স্থাপনের মাধ্যমে রোহিঙ্গা নারী ও কিশোরীদের মনো-সামাজিক, রেফারেল, কাউন্সিলিং, মিডওয়াইফারি, ডিগনিটি কিট বিতরণ (নারী ও কিশোরীদের) এবং ওয়াশ সাপোর্ট সেবা প্রদান কার্যক্রম পরিচালনার জন্য বিশেষ ভাবে অনুমতি কামনা করছি।

স্বাক্ষর

মো: শামীম সরদার
কর্মসূচী ব্যবস্থাপক (GBViE) প্রকল্প
মুক্তি কক্সবাজার।
মোবা: ০১৭১২-৯৪৫-৩২১

Seen
Approved
Sayeed Abulhish Al Mamun
Community Rehabilitation Asst
Camp-12
Ukhiya Cox's Bazar



HEAD OFFICE: SARADA BHABAN, GOLDIGHIR PAR, COX'S BAZAR, BANGLADESH.
Tel : 88-0341-62558, Fax: 0341-51103, E-mail: mukticox@gmail.com, Web: www.muktibd.org

Camp 14, Block- A-2, Hakimpara, Friendly Space (WFS), Ukhiya



কক ২৬৯৩০৮১

জমি ভাড়ার চুক্তিনামা

এ চুক্তি অদ্য ৬ মার্চ -২০২১ইং তারিখে সম্পাদিত ও স্বাক্ষরিত হল।

পক্ষ সমূহ

জনাব সিরাজ মিয়া, পিতা: মোজাহের মিয়া, মাতাঃ জোহরা বেগম, গ্রাম: ঘোনার পাড়া, ফালংখালী ডাকঘরঃ বালুখালী থানা: উখিয়া, জেলা : কক্সবাজার।

.....১ম পক্ষ

এবং

বিমল চন্দ্র কে সরকার, প্রধান নির্বাহী, মুক্তি কক্সবাজার, সারদা স্ট্রবন , গোল দিঘীর পাড়, কক্সবাজার।

.....২য় পক্ষ

বাড়ীর বিবরণ

প্রথম পক্ষ জনাব সিরাজ মিয়া উপরোক্ত ঠিকানার জমির একক স্বত্বাধিকারী। দ্বিতীয় পক্ষ তাদের সংস্থা কর্তৃক বাস্তবায়নাধীন (Providing Quality GBV Prevention and Response for the Rohingya and Host Communities in Cox's Bazar to increase Community wellbeing) প্রকল্পের কার্যক্রম পরিচালনার জন্য উক্ত জমিতে আনুমানিক ৮০ ফিট দৈর্ঘ্য এবং ৫০ ফিট প্রস্থ জায়গা ভাড়া নেয়ার প্রস্তাব করলে উভয় পক্ষ পারস্পরিক সমঝোতার ভিত্তিতে নিম্নলিখিত শর্ত সাপেক্ষে ভাড়া দিতে ও নিতে সম্মত হন।

শর্তাবলী:

ক. চুক্তির মেয়াদ

- এই জমি ভাড়া চুক্তি আগামী ০১.০৫.২০২১ ইং হতে ৩১.১২.২০২২ইং পর্যন্ত মোট ০১ (এক) বছর ৮ (অট) মাস মেয়াদের জন্য বলবৎ থাকবে এবং উভয় পক্ষ এ বাড়ি ভাড়া চুক্তি নবায়ন করার প্রয়োজন মনে করলে চুক্তির মেয়াদ শেষ হওয়ার ০২ মাস (৬০ দিন) পূর্বে চুক্তি নবায়ন করার প্রয়োজনীয় ব্যবস্থা গ্রহণ করবেন। তবে নবায়নের জন্য প্রস্তাবিত মেয়াদের মাসিক ভাড়ার পরিমাণ (যদি প্রযোজ্য হয়) উভয় পক্ষের মধ্যে আলোচনা সাপেক্ষে নির্ধারিত হবে। প্রকাশ থাকে যে, চুক্তির মেয়াদান্তে চুক্তির মেয়াদ বর্ধিত করা না হলে উক্ত চুক্তির কার্যকারিতা আপন-আপনি শেষ হয়ে যাবে।
- চুক্তির মেয়াদ বলবৎ থাকা অবস্থায় ১ম পক্ষ কোন অবস্থাতে নির্ধারিত জমির ভাড়া বৃদ্ধি করতে পারবে না।
- চুক্তির মেয়াদ বলবৎ থাকা অবস্থায় যে কোন সময় উভয় পক্ষ ০২ মাসের (৬০ দিনের) লিখিত নোটিশে চুক্তি বাতিল করতে পারবে। অর্থাৎ যদি ২য় পক্ষ যেহেতু জমি থেকে চলে যেতে চায় অথবা ২য় পক্ষকে ১ম পক্ষ কর্তৃক জমি খালি করতে অনুরোধ জানানো হয় তবে ২ মাস (৬০ দিন) পূর্বে অগ্রিম লিখিত নোটিশ দিতে হবে। চুক্তির মেয়াদান্তে ১ম পক্ষ উক্ত জমি যথা সময়ে বুকে নেয়ার জন্য প্রয়োজনীয় ব্যবস্থা গ্রহণ করবেন।

উপরে বর্ণিত (৩) অনুচ্ছেদের প্রেক্ষিতে যদি প্রথম পক্ষ জমির দখল বুকে নিতে ব্যর্থ হন তবে দ্বিতীয় পক্ষ উক্ত জায়গা খালি করে চলে যেতে পারবেন এবং পরবর্তীতে উক্ত জমির কোন প্রকার ক্ষতি হলে তার জন্য দ্বিতীয় পক্ষ দায়ী থাকবেন না।

“দেশপ্রেমের শপথ নিন. চারদিন পাকিস্তানকে বিদায় দিন”



কক ২৬৯৩০৮২

পাতা-০২

বিশেষজ্ঞ
বিদ্যমান পক্ষের
স্বাক্ষর

খ. মাসিক ভাড়ার পরিমাণঃ

এই জমির মাসিক ভাড়া বাবদ ১৬৮৪২/- টাকা মাত্র (ষোল হাজার আটশত বিয়াল্লিশ টাকা) নির্ধারণ করা হইল। দ্বিতীয় পক্ষ মাসিক ভাড়ার উপর সরকারী নিয়ম অনুযায়ী প্রযোজ্য হারে আয় কর কর্তন করে এবং প্রযোজ্য হারে ভ্যাট সংযোজন করে বাকী টাকা পরবর্তী মাসের ১০ তারিখের মধ্যে একাউন্ট পেয়ী চেকের মাধ্যমে মাসের ভাড়া হিসেবে প্রদান করবেন। প্রথম পক্ষ প্রতি মাসে ভাড়ার রসিদ / বিল দ্বিতীয় পক্ষকে প্রদান করবেন।

গ. চুক্তির অন্যান্য শর্তাবলী:

দ্বিতীয় পক্ষ কর্তৃক পালনীয়/করণীয়

১. দ্বিতীয় পক্ষ ভাড়া কৃত জমিতে তাদের ব্যবহৃত মিটার রিডিং অনুযায়ী বিদ্যুৎ বিল প্রদান করবেন। পরিশোধিত বিদ্যুৎ বিলের একটা কপি (সাব মিটার) দ্বিতীয় পক্ষ সংরক্ষণ করবেন।
২. দ্বিতীয় পক্ষ ভাড়া কৃত জমিতে তাদের অফিসিয়াল স্থাপনা, বং, ব্রাঞ্চিং, এসি স্থাপন, বৈদ্যুতিক সরঞ্জাম স্থাপন, অন্যান্য ফিটিংস, প্রয়োজনীয় ছোট-খাট পার্টিশন/মেরামত ও নির্মাণ কাজ করতে এবং সুবিধামত জায়গায় প্রতিষ্ঠানের সাইন বোর্ড লাগাতে/টানাতে পারবেন। এতে প্রথম পক্ষ কোন প্রকার আপত্তি করতে পারবে না।
৩. ভাড়া কৃত জমিতে দ্বিতীয় পক্ষ যদি অবকাঠামোগত কোন পরিবর্তন বা পরিবর্ধন করার প্রয়োজন মনে করে তবে সে ক্ষেত্রে প্রথম পক্ষের লিখিত পূর্ব অনুমোদন নেবেন।
৪. দ্বিতীয় পক্ষ ভাড়া কৃত সম্পত্তিতে ভাড়াটে হিসেবে ভোগকালে অথবা সংস্থার কার্যক্রম পরিচালনা কালে প্রথম পক্ষ কোন প্রকার অসুবিধা / প্রতিবন্ধকতা সৃষ্টি করতে পারবেনা।
৫. দ্বিতীয় পক্ষ ভাড়া কৃত জমিতে ক্ষতিকর, অসামাজিক ও রট্টনপ্রসূই কোন কাজ করতে পারবেন না এবং অন্য কোন পক্ষের কাছে কোন প্রকার উপভাড়া বা হস্তান্তর করতে পারবেন না।
৬. ভাড়া কৃত জমি ছেড়ে / বালি করে দেয়ার সময় দ্বিতীয় পক্ষ কর্তৃক সংস্থাপিত / সংযোজিত সকল প্রকার ঘর-বাড়ি, আসবাবপত্র এবং সরঞ্জামাদি দ্বিতীয় পক্ষ খুলে নিয়ে যেতে পারবেন। এতে প্রথম পক্ষ কোন প্রকার বাধা প্রদান করতে পারবেন না। তবে জমির বৃহৎ কোন ক্ষতিও করতে পারবেন না। এ ধরনের কোন ক্ষতি সংঘটিত হলে দ্বিতীয় পক্ষ তা নিজ খরচে মেরামত করে দিবেন।

প্রথম পক্ষ কর্তৃক পালনীয়/করণীয়

১. প্রথম পক্ষ তফসিলে বর্ণিত সম্পত্তির উপর বাংলাদেশ সরকারের নির্ধারিত পৌরকর, খাজনা ও অন্যান্য সকল প্রকার কর ইত্যাদি নিজ দায়িত্বে সময়মত পরিশোধ করবেন। এ ধরনের সরকার কর্তৃক আরোপিত কর, খাজনা বা অন্যান্য ধার্যকৃত সরকারী ফি-র জন্য দ্বিতীয় পক্ষকে কোন প্রকার ভোগান্তির স্বীকার করা যাবে না।

“দেশপ্রেমের শপথ নিন, দুর্নীতিকে বিদায় দিন”

চলমান পাতা-৩



কই ২৬৯৩০৮৩

৳১০০ দে দে সরকার
১০/১১/১৯৮৩
বিজ্ঞান চন্দ্র দে সরকার

পাতা-৩

কোন প্রকার নোটিশ বা চিঠি আদান প্রদানের প্রয়োজন হলে উভয় পক্ষ নিম্নলিখিত ঠিকানায় যোগাযোগ করবেন।

উপরোক্ত চুক্তির শর্তানুসারে উভয় পক্ষের মধ্যে কোন প্রকার বিরোধের সৃষ্টি হলে নিজেরা (উভয় পক্ষ) সমাধান করবেন। তবে কোন কারণে তা করতে না পারলে বাংলাদেশের প্রচলিত আইন অনুসারে সে সমস্যার সমাধান করার জন্য আইনের আশ্রয় নিতে পারবেন।

আমরা উভয় পক্ষ স্ব-জ্ঞানে, অন্যের প্ররোচনা ব্যতিরেকে চুক্তিতে উল্লেখিত শর্তসমূহ মেনে নিয়ে এবং নিম্নে উল্লেখিত সাক্ষীগণের উপস্থিতিতে অত্র বাড়ি ভাড়া চুক্তিনামায় স্বাক্ষর করলাম।

প্রথম পক্ষ: সিরাজ মিয়া

সিরাজ মিয়া
পিতা: মোজাহের মিয়া
গ্রাম: ঘোনার পাড়া
থানা: উখিয়া
জেলা: কক্সবাজার।

দ্বিতীয় পক্ষ:

বিজ্ঞান চন্দ্র দে সরকার

বিমল চন্দ্র দে সরকার
প্রধান নির্বাহী
মুক্তি কক্সবাজার
সারদা ভবন, গোল দিঘীর পাড়,
কক্সবাজার।

সাক্ষীগণের নাম, স্বাক্ষর ও ঠিকানা

০১. আব্দুল ওলিল - পিতা - হাজি আব্দুল হামিদ - হাফিজ মাতা -

০২. মুহম্মদ কবির - পিতা - হাজি মোজাহের মিয়া - হাফিজ মাতা -

০৩. তিলন পাল - পিতা: সুবি পাল, মুক্তি কক্সবাজার,

০৪. আব্দুল ওলিল - পিতা আব্দুল হামিদ - হাফিজ মাতা -
“দেশপ্রেমের শপথ নিন, দুর্নীতিকে বিদায় দিন”



কই ২৬৯৩০৭৮

জমি ভাড়ার চুক্তি নামা

এ চুক্তি অদ্য ৬ মার্চ ২০২১ইং তারিখে সম্পাদিত ও স্বাক্ষরিত হল।

সাহাব উদ্দিন পিতা মৃত আবদুল করিম মন্ডার সাং বালুখালী, ১নং ওয়ার্ড, পালাংখালী ইউনিয়ন থানা উখিয়া জেলা কক্সবাজার

..... ১ম পক্ষ

বিমল চন্দ্র দে সরকার, প্রধান নির্বাহী, মুক্তি কক্সবাজার, সারাদ ভবন, গোল দিঘীর পাড়, কক্সবাজার পৌরসভা থানা ও জেলা কক্সবাজার

..... ২য় পক্ষ।

বাড়ীর/জমির বিবরণ ৪-

দাগ নং-২৬১, ৪০১, ৪০৫, খতিয়ান নং-বি.এস ১৫, মৌজা-উখিয়ার ঘাট, মোট জমির পরিমাণ ৩-৫২ শতক হইতে উল্লেখিত দাগাদির আন্দর ৯.১৬ শতক জমি।

প্রথম পক্ষ সাহাব উদ্দিন উল্লেখিত ঠিকানার জমির একক স্বত্বাধিকারী হয়। দ্বিতীয় পক্ষ তাদের সংস্থা কর্তৃক বাস্তবায়নাধীন (Saving Lives and Dignity of Undocumented Myanmar Nationals, Women and Girls through Multi sectoral Prevention and Response to Survivors of Gender Based Violence), প্রকল্পের কার্যক্রম পরিচালনার জন্য উক্ত জমিতে আনুমানিক ৮০ ফিট দৈর্ঘ্য এবং ৫০ ফিট প্রস্থ জায়গা ভাড়া নেওয়ার প্রস্তাব করিলে উভয় পক্ষ পারস্পরিক সমঝোতার ভিত্তিতে নিম্নলিখিত শর্ত সাপেক্ষে ভাড়া দিতে ও নিতে সম্মত হন।

শর্তাবলী ৪-

ক. চুক্তির মেয়াদ-

১. এই জমির ভাড়া চুক্তি আগামী ০১/০৫/২০২১ইং হতে ৩১/১২/২০২২ইং তারিখ পর্যন্ত মোট ১ (এক) বৎসর ৮ মাস মেয়াদের জন্য বলবৎ থাকবে এবং উভয় পক্ষ এই বাড়ী ভাড়া চুক্তি নবায়ন করার প্রয়োজন মনে করিলে চুক্তি মেয়াদ শেষ হওয়ার ১ মাস (৩০ দিন) পূর্বে চুক্তি নবায়ন করার প্রয়োজনীয় ব্যবস্থা করিবেন। তবে নবায়নের জন্য প্রস্তাবিত মেয়াদের মাসিক ভাড়া বাৎসরিক শতকরা ৫% হারে (যদি প্রযোজ্য হয়) উভয় পক্ষের মধ্যে আলোচনা সাপেক্ষে নির্ধারিত হইবে। প্রকাশ থাকে যে, চুক্তির মেয়াদান্তে চুক্তির মেয়াদ বর্ধিত করা না হলে, উক্ত চুক্তির কার্যকারিতা আপনা-আপনি শেষ হয়ে যাবে।

২. চুক্তির মেয়াদ বলবৎ থাকা অবস্থায় ১ম পক্ষ কোন অবস্থাতেই নির্ধারিত জমির ভাড়া বৃদ্ধি করিতে পারিবেন না।

৩. চুক্তির মেয়াদ বলবৎ থাকা অবস্থায় যে কোন সময় উভয় পক্ষ ১ মাসের (৩০ দিনের) লিখিত নোটিশে চুক্তি বাতিল করতে পারিবেন। অর্থাৎ যদি ২য় পক্ষ স্বেচ্ছায় জমি থেকে চলে যেতে চাহেন অথবা ২য় পক্ষকে ১ম পক্ষ কর্তৃক জমি খালি করতে অনুরোধ জানানো হয়, তবে ২ মাস (৬০ দিন) পূর্বে অগ্রিম লিখিত নোটিশ দিতে হবে। চুক্তির মেয়াদান্তে ১ম পক্ষ উক্ত জমি যথাসময়ে বুকে নেয়ার জন্য প্রয়োজনীয় ব্যবস্থা গ্রহণ করবেন। ৪. উপরে বর্ণিত ৩নং অনুচ্ছেদের প্রেক্ষিতে যদি ১ম পক্ষ জমির দখল বুকে নিতে ব্যর্থ হন অথবা ১ম পক্ষ কোন কারণে দেশের বাইরে অবস্থান করেন, তবে ২য় পক্ষ জমির ভাড়াকৃত সমস্ত লেনদেন ১ম পক্ষের মনোনীত ক্ষমতা প্রাপ্ত ব্যক্তি অথবা তাহার ওয়ারিশের নিকট জমি বুকাইয়া দিয়া চলিয়া যাইতে পারিবেন। যদি কোন কারণে জমি ১ম পক্ষ অথবা তাহার মনোনীত ক্ষমতা প্রাপ্ত ব্যক্তি ও ১ম পক্ষের ওয়ারিশগণের নিকট জমি বুকাইয়া দেওয়ার পর কোন ক্ষতিসাধিত হয়, তবে তাহার দায়দায়িত্ব ২য় পক্ষ বহন করিবেন। জের....

“দেশপ্রেমের শপথ নিন, দুর্নীতিকে বিদায় দিন”



কক ২৬৯৫০৭৯

১৯৭৯ সালের ১০ মার্চ
বিজ্ঞান, চন্দ্র ও মহাকাশ
বিভাগ

খ. মাসিক ভাড়ার পরিমান-

এই জমির মাসিক ভাড়া বাবদ (টাকায় সহ) ১৭.৮৯৫/= (সতের হাজার আট শত পচানব্বই) টাকা নির্ধারণ করা হইল। ২য় পক্ষ মাসিক ভাড়ার উপর সরকারী নিয়ম অনুযায়ী প্রযোজ্য হারে ভ্যাট সংযোজন করিয়া ২য় পক্ষের অফিস কর্তৃপক্ষ উক্ত নির্ধারিত ভ্যাট পরিশোধ করিয়া বাড়ী ভাড়ার টাকা পরবর্তী মাসের ১০ তারিখের মধ্যে একাউন্ট চেকের মাধ্যমে মাসের ভাড়া হিসাবে ১ম পক্ষকে প্রদান করিবেন। ১ম পক্ষ মাসিক ভাড়া গ্রহণের পর প্রতি মাসে ২য় পক্ষের বরাবরে ভাড়া প্রাপ্তির রশিদ প্রদান করিবেন।

গ. চুক্তির অন্যান্য শর্তাবলী-

দ্বিতীয় পক্ষ কর্তৃক পালনীয়/করণীয়

১. ২য় পক্ষ ভাড়া কৃত বাড়ীতে তাদের ব্যবহৃত বিদ্যুৎ মিটার রিডিং অনুযায়ী বিদ্যুৎ বিল প্রদান করিবেন। পরিশোধিত বিদ্যুৎ বিলের একটি কপি (সাব মিটার) ২য় পক্ষ সংরক্ষণ করিবেন।
২. ২য় পক্ষ ভাড়া কৃত জমিতে তাদের অফিসিয়াল স্থাপনা রং, ব্র্যান্ডিং, এসি স্থাপন, বৈদ্যুতিক সরঞ্জাম স্থাপন, অন্যান্য ফিটিংস, প্রয়োজনীয় ছোটখাট পাটিশান/মেরামতের নির্মাণ কাজ সুবিধামত জায়গায় সাইনবোর্ড লাগাতে/টাংগাতে পারিবেন। এতে ১ম পক্ষ কোন প্রকার আপত্তি করিতে পারিবেন না।
৩. ভাড়া কৃত জমিতে ২য় পক্ষ যদি অবকাঠামো গত কোন পরিবর্তন বা পরিবর্ধন করার প্রয়োজন মনে করেন, তবে সে ক্ষেত্রে ১ম পক্ষের লিখিত পূর্ব অনুমোদন নিতে হইবে।
৪. ২য় পক্ষ ভাড়া কৃত জমিতে ভাড়াটে হিসাবে ভোগ দখলকালে অথবা সংস্থার কার্যক্রম পরিচালনা কালে ১ম পক্ষ কোন প্রকার অসুবিধা/প্রতিবন্ধকতা সৃষ্টি করিতে পারিবেন না বা কাহারো দ্বারা করাইতে পারিবেন না।
৫. ২য় পক্ষ ভাড়া কৃত জমিতে ক্ষতিকর, অসামাজিক ও রাষ্ট্রদ্রোহী কোন কাজ করিতে পারিবেন না এবং অন্য কোন ৩য় পক্ষকে উপ ভাড়াটে প্রদান বা হস্তান্তর করিতে পারিবেন না। ভাড়া কৃত জমি ছাড়িয়া/খালি করিয়া দেওয়ার সময় ২য় পক্ষ কর্তৃক সংস্থাপিত/সংযোজিত সকল প্রকার ঘর বাড়ী, আসবাব পত্র এবং সরঞ্জামাদি ২য় পক্ষ অপসারণ করিয়া নিয়া যাইতে পারিবেন। ইহাতে ১ম পক্ষের কোনরূপ বাধাবিঘ্ন থাকিবে না। ভাড়া কৃত জমিতে কোন বড় ধরনের ক্ষতি ২য় পক্ষ করিতে পারিবেন না। যদি কোন কারণে ভাড়া কৃত জমিতে বড় ধরনের কোন ক্ষতিসাধিত হয়, তবে তাহা ২য় পক্ষ বহন করিতে বাধ্য থাকিবেন।

১ম পক্ষ কর্তৃক পালনীয়/করণীয়

১. ১ম পক্ষ তৃপনশীল বর্ণিত সম্পত্তির উপর বাংলাদেশ সরকারের নির্ধারিত পৌর কর বাজনা ও অন্যান্য সকল প্রকার কর ইত্যাদি নিজ দায়িত্বে সময়মত পরিশোধ করিবেন। এই ধরনের সরকার কর্তৃক আরোপিত কর বাজনা ও অন্যান্য ধার্যকৃত সরকারী ফির জন্য ২য় পক্ষকে কোন প্রকার ভোগান্তি স্বীকার করা যাইবে না। কোন প্রকার নোটিশ চিঠি আদান প্রদানের প্রয়োজন হলে, উভয় পক্ষ নিম্নলিখিত ঠিকানায় যোগাযোগ করিবেন।

উপরোক্ত চুক্তি শর্তানুসারে উভয় পক্ষের মধ্যে কোন প্রকার বিরোধ সৃষ্টি হলে, নিজেরা (উভয় পক্ষ) সমাধান করিবেন। তবে কোন কারণে তাহা করিতে না পারিলে বাংলাদেশ প্রচলিত আইন অনুসারে সেই সমস্যা সমাধান করার জন্য উভয় পক্ষ আইনের আশ্রয় গ্রহণ করিতে পারিবেন। জের....

“দেশপ্রেমের শপথ নিন, দুর্নীতিকে বিদায় দিন”



কই ২৬৯৩০৮০

বিশ্বাসী হও
বিশ্বাসী হও

আমরা উভয় পক্ষ স্বজ্ঞানে, স্বেচ্ছায়, অন্যের প্ররোচনা ব্যতিরেকে চুক্তিতে লিখিত শর্তসমূহ মানিয়া নিয়া এবং নিজে উল্লেখিত স্বাক্ষীগণের উপস্থিতিতে জমি/বাড়ী ভাড়া চুক্তি নামায় স্বাক্ষর করিলাম।

১ম পক্ষ মোহাম্মদ হাফিজ উদ্দিন সাহাব উদ্দিন পিতা মৃত আবদুল লতিফ মাস্টার সাং বালুখালী, ১নং ওয়ার্ড, পালংখালী ইউনিয়ন থানা উখিয়া জেলা কক্সবাজার	২য় পক্ষ বিশ্বাসী হও দে সরকার বিমল চন্দ্র দে সরকার, প্রধান নির্বাহী, মুক্তি কক্সবাজার, সারদা ভবন, গোল দিঘীর পাড়, কক্সবাজার পৌরসভা থানা ও জেলা কক্সবাজার
--	--

স্বাক্ষীগণের নাম, স্বাক্ষর ও ঠিকানা :-

- ১। মনোজ্ঞ কক্সবাজার লোক মুক্ত হওয়ার হোমেন হোমেন হ্যাং - উজ্জ্বল হোমেন হোমেন হ্যাং, থানা - উজ্জ্বল, কক্সবাজার,
- ২। মোহাম্মদ হাফিজ উদ্দিন, পিতা - মৃত আবদুল লতিফ মাস্টার, সাং বালুখালী, ১নং ওয়ার্ড, পালংখালী ইউনিয়ন, থানা উখিয়া জেলা কক্সবাজার
- ৩। মোহাম্মদ হাফিজ উদ্দিন, পিতা - মৃত আবদুল লতিফ মাস্টার, সাং বালুখালী, ১নং ওয়ার্ড, পালংখালী ইউনিয়ন, থানা উখিয়া জেলা কক্সবাজার
- ৪। মোহাম্মদ হাফিজ উদ্দিন, পিতা - মৃত আবদুল লতিফ মাস্টার, সাং বালুখালী, ১নং ওয়ার্ড, পালংখালী ইউনিয়ন, থানা উখিয়া জেলা কক্সবাজার

“দেশপ্রেমের শপথ নিন, দুর্নীতিকে বিদায় দিন”

৳১০০		৳১০০
একশত টাকা		
কহ	২৬৯৩০৮৪	১৪/১২/১৯
জমি ভাড়ার চুক্তিনামা		
এ চুক্তি অন্য ৬ মার্চ -২০২১ইং তারিখে সম্পাদিত ও স্বাক্ষরিত হল।		
পক্ষ সমূহ		
জনাব নবী হোসেন, পিতা: মৃতঃ সুলতান আহমদ, মাতাঃ ফাতেমা বাতুন, গ্রাম: লেনা পশ্চিম পাড়া, ডাকঘরঃ রংগীখালী থানা: টেকনাফ, জেলা : কক্সবাজার।		
.....১ম পক্ষ		
এবং		
বিমল চন্দ্র দেব সরকার, প্রধান নির্বাহী, মুক্তি কক্সবাজার, সাবনা ভবন, গোম দিঘীর পাড়, কক্সবাজার।		
.....২য় পক্ষ		
বাড়ীর বিবরণ		
প্রথম পক্ষ জনাব সিরাজ মিয়া উপরোক্ত ঠিকানার জমির একক স্বত্বাধিকারী। দ্বিতীয় পক্ষ তাদের সংস্থা কর্তৃক বাস্তবায়নধীন (Providing Quality GBV Prevention and Response for the Rohingya and Host Communities in Cox's Bazar to increase Community wellbeing) প্রকল্পের কার্যক্রম পরিচালনার জন্য উক্ত জমিতে আনুমানিক ৭০ ফিট দৈর্ঘ্য এবং ৪০ ফিট প্রস্থ জায়গা ভাড়া নেয়ার প্রস্তাব করলে উভয় পক্ষ পারস্পরিক সমঝোতার ভিত্তিতে নিম্নলিখিত শর্ত সাপেক্ষে ভাড়া দিতে ও নিতে সম্মত হন।		
শর্তাবলী:		
ক. চুক্তির মেয়াদ		
১. এই জমি ভাড়া চুক্তি আগামী ০১.০৫.২০২১ ইং হতে ৩১.১২.২০২২ ইং পর্যন্ত মোট ০১ (এক) বছর ৮ (আট) মাস মেয়াদের জন্য বলবৎ থাকবে এবং উভয় পক্ষ এ বাড়ি ভাড়া চুক্তি নবায়ন করার প্রয়োজন মনে করলে চুক্তির মেয়াদ শেষ হওয়ার ০২ মাস (৬০ দিন) পূর্বে চুক্তি নবায়ন করার প্রয়োজনীয় ব্যবস্থা গ্রহণ করবেন। তবে নবায়নের জন্য প্রস্তাবিত মেয়াদের মাসিক ভাড়ার পরিমাণ (যদি প্রযোজ্য হয়) উভয় পক্ষের মধ্যে আলোচনা সাপেক্ষে নির্ধারিত হবে। প্রকাশ থাকে যে, চুক্তির মেয়াদান্তে চুক্তির মেয়াদ বর্ধিত করা না হলে উক্ত চুক্তির কার্যকারিতা আপনা-আপনি শেষ হয়ে যাবে।		
২. চুক্তির মেয়াদ বলবৎ থাকা অবস্থায় ১ম পক্ষ কোন অবস্থাতে নির্ধারিত জমির ভাড়া বৃদ্ধি করতে পারবে না।		
৩. চুক্তির মেয়াদ বলবৎ থাকা অবস্থায় যে কোন সময় উভয় পক্ষ ০২ মাসের (৬০ দিনের) লিখিত নোটিশে চুক্তি বাতিল করতে পারবে। অর্থাৎ যদি ২য় পক্ষ যেকোনো জমি থেকে চলে যেতে চায় অথবা ২য় পক্ষকে ১ম পক্ষ কর্তৃক জমি খালি করতে অনুরোধ জানানো হয় তবে ২ মাস (৬০ দিন) পূর্বে অগ্রিম লিখিত নোটিশ দিতে হবে। চুক্তির মেয়াদান্তে ১ম পক্ষ উক্ত জমি যথা সময়ে বুকে নেয়ার জন্য প্রয়োজনীয় ব্যবস্থা গ্রহণ করবেন।		
উপরে বর্ণিত (৩) অনুচ্ছেদের প্রেক্ষিতে যদি প্রথম পক্ষ জমির দখল বুকে নিতে ব্যর্থ হন তবে দ্বিতীয় পক্ষ উক্ত জায়গা খালি করে চলে যেতে পারবেন এবং পরবর্তীতে উক্ত জমির কোন প্রকার ক্ষতি হলে তার জন্য দ্বিতীয় পক্ষ দায়ী থাকবেন না।		
“দেশপ্রেমের শপথ নিন, দুর্নীতিকে বিদায় দিন”		
চলমান পাতা-২		



কহ ২৬৯৩০৮৫

৭৪১২১৬৭
বিস্তারিত হতে সংস্কার

পাতা-০২

খ. মাসিক ভাড়ার পরিমাণঃ

এই জমির মাসিক ভাড়া বাবদ ১০,৫২৬/- টাকা মাত্র (দশ হাজার পাঁচশত ছাব্বিশ টাকা) নির্ধারণ করা হইল। দ্বিতীয় পক্ষ মাসিক ভাড়ার উপর সরকারী নিয়ম অনুযায়ী প্রযোজ্য হারে আয় কর কর্তন করে এবং প্রযোজ্য হারে ভাড়াটি সংযোজন করে বাকী টাকা পরবর্তী মাসের ১০ তারিখের মধ্যে একাউন্ট পেয়ী চেকের মাধ্যমে মাসের ভাড়া হিসেবে প্রদান করবেন। প্রথম পক্ষ প্রতি মাসে ভাড়ার রসিদ / বিল দ্বিতীয় পক্ষকে প্রদান করবেন।

গ. চুক্তির অন্যান্য শর্তাবলী:

দ্বিতীয় পক্ষ কর্তৃক পালনীয়/করণীয়

১. দ্বিতীয় পক্ষ ভাড়া কৃত জমিতে তাদের ব্যবহৃত মিটার রিডিং অনুযায়ী বিদ্যুৎ বিল প্রদান করবেন। পরিশোধিত বিদ্যুৎ বিলের একটা কপি (সাব মিটার) দ্বিতীয় পক্ষ সংরক্ষণ করবেন।
২. দ্বিতীয় পক্ষ ভাড়া কৃত জমিতে তাদের অফিসিয়াল স্থাপনা, রং, ব্রাডিং, এসি স্থাপন, বৈদ্যুতিক সরঞ্জাম স্থাপন, অন্যান্য ফিটিংস, প্রয়োজনীয় ছোট-খোট প্যাটিন/মেরামত ও নির্মাণ কাজ করতে এবং সুবিধামত জায়গায় প্রতিষ্ঠানের সাইন বোর্ড লাগাতে/টানাতে পারবেন। এতে প্রথম পক্ষ কোন প্রকার আপত্তি করতে পারবে না।
৩. ভাড়া কৃত জমিতে দ্বিতীয় পক্ষ যদি অবকাঠামোগত কোন পরিবর্তন বা পরিবর্ধন করার প্রয়োজন মনে করে তবে সে ক্ষেত্রে প্রথম পক্ষের লিখিত পূর্ব অনুমোদন নেবেন।
৪. দ্বিতীয় পক্ষ ভাড়া কৃত সম্পত্তিতে ভাড়াটে হিসেবে ভোগকালে অথবা সংস্থার কার্যক্রম পরিচালনা কালে প্রথম পক্ষ কোন প্রকার অসুবিধা / প্রতিবন্ধকতা সৃষ্টি করতে পারবেন না।
৫. দ্বিতীয় পক্ষ ভাড়া কৃত জমিতে ক্ষতিকর, অসামাজিক ও রাষ্ট্রদ্রোহী কোন কাজ করতে পারবেন না এবং অন্য কোন পক্ষের কাছে কোন প্রকার উপভাড়া বা হস্তান্তর করতে পারবেন না।
৬. ভাড়া কৃত জমি ছেড়ে / খালি করে দেয়ার সময় দ্বিতীয় পক্ষ কর্তৃক সংস্থাপিত / সংযোজিত সকল প্রকার ঘর-বাড়ি, আসবাবপত্র এবং সরঞ্জামাদি দ্বিতীয় পক্ষ খুলে নিয়ে যেতে পারবেন। এতে প্রথম পক্ষ কোন প্রকার বাধা প্রদান করতে পারবেন না। তবে জমির বৃহৎ কোন ক্ষতিও করতে পারবেন না। এ ধরনের কোন ক্ষতি সংঘটিত হলে দ্বিতীয় পক্ষ তা নিজ খরচে মেরামত করে দিবেন।

প্রথম পক্ষ কর্তৃক পালনীয়/করণীয়

১. প্রথম পক্ষ তফসিলে বর্ণিত সম্পত্তির উপর বাংলাদেশ সরকারের নির্ধারিত পৌরস্বত্ব, খাজনা ও অন্যান্য সকল প্রকার কর ইত্যাদি নিজ দায়িত্বে সময়মত পরিশোধ করবেন। এ ধরনের সরকার কর্তৃক আরোপিত কর, খাজনা বা অন্যান্য ধার্যকৃত সরকারী ফি-র জন্য দ্বিতীয় পক্ষকে কোন প্রকার ভোগান্তির স্বীকার করা যাবে না।

“দেশপ্রেমের শপথ নিন. দর্নীতিকে বিদায় দিন”

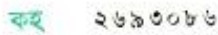

... १३६८७४८

০৪. গুহর দুনিয়ায় হাজার হাজার, উদ্ভিদ নগর, জীবন সঞ্চার,
 আত্ম-ত্যাগের (জীবন-অর্পণ) সমগ্র মানব জীবন - সুখ-স্বাস্থ্য
 দেশপ্রেমের শপথ নিন, দুর্নীতিকে বিদায় দিন”

World Bank requirements for Camp 6 WFS site Assessment report

WFS land and House rent Agreement: IRC got this pieces of land at camp-06 direct from CIC (Govt.). Since there is no personal owner of this land, land and house rent is not applicable for this land.

NID from WFS land and House Owner: N/A

WFS services:

GBV program: IRC provides case management service under GBV response service and implements Girl Shine, EMAP, SASA! under GBV prevention activities in the WFS of camp 6. Under the support of UNFPA, IRC will be implementing SASA!, community outreach, GBV case management and SRH services.

- SASA! is a comprehensive and systematic approach to community mobilization that seeks to address violence against women and girls by engaging communities in dialogues through unpacking both positive and negative power and the impacts of both upon women and girls. SASA! uses four strategies: local activism, media and advocacy, communication materials, and training—with the specifics of intervention activities evolving in response to community priorities and characteristics. In the initial phase, community activists (CAs), men and women interested in issues relating to violence, are selected and trained. These activists then work through the subsequent phases of the SASA! curriculum with a central focus throughout on discussions of 'power'. After being introduced to new ways of thinking about power and being encouraged to think about gender-related power imbalances in their own lives and communities, the CAs engage their communities in the same critical reflection—not only about the ways in which men and women may misuse power, with consequences for their relationships and communities, but also how people can use their power positively to foster change at an individual and community level.
- GBV case management is a structured method for providing logistical and emotional support and follow-up to a survivor through which their problems are identified, they are informed of options available to them, and provided with referrals when necessary. In our own programming, with survivor centered, Do No Harm approaches at its core, the IRC provides quality case management services including psychosocial support (PSS) and referral services especially for the Clinical Management of Rape to GBV survivors. Our midwives and case workers work hand in hand to support the GBV survivors while maintaining the survivor's confidentiality. As an active member of GBVIMS Task Team, the IRC ensures storage, analyzing and sharing the data and report through sticking up to information sharing protocol (ISP) to understand the overall GBV situation. IRC also does service mapping on a regular basis.
- Dignity kit distribution: IRC distributes dignity kits on need basis, especially the GBV survivors who comes for case management service in camp 6.
- Community Outreach: As part of prevention programming, IRC volunteers go door-to-door to provide information on GBV risk mitigation and other information including COVID 19.

Sexual and reproductive health (SRH) services-

IRC provides the following services:

- Family Planning (short & long acting reversible method)
- STI (sexually transmitted infections)
- CMR (Clinical management of Rape)
- MR (menstrual regulation)
- SAC (safe abortion care)
- Male engagement activity, Outreach activities.
- Provide survivors of GBV to psychosocial and case management support;
- Provide the community with information on services

Design of WFS

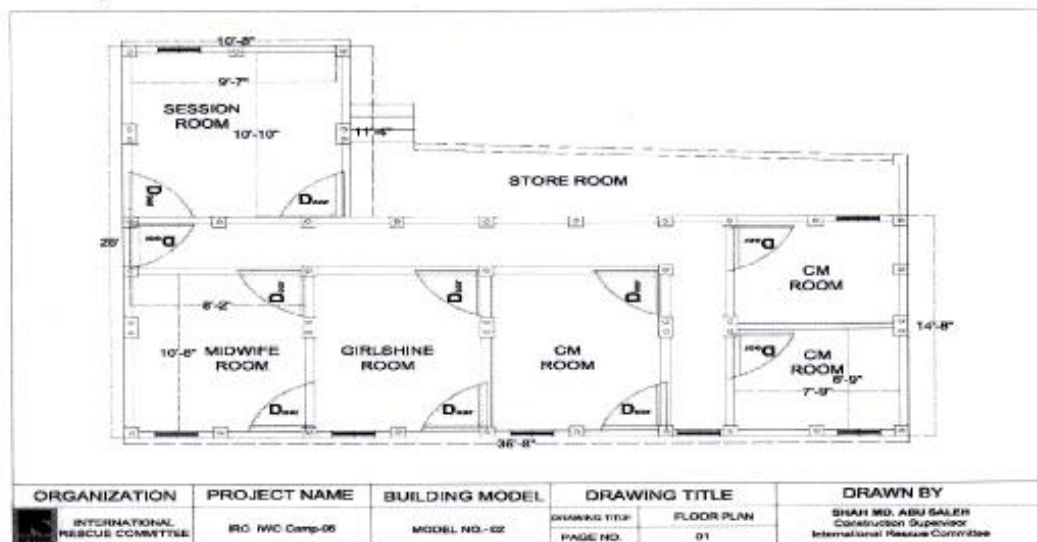

Challenges:

- No separate space for recreational activities.
- No space for male volunteers and beneficiaries.
- No exit door.
- No ramp.
- No separate confidential space for breast feeding beneficiaries.

Details about each room:

There are 7 rooms in the WFS of camp 6 in total. 3 room for case management, 1 for Girl Shine, 1 for conducting sessions with women, 1 for midwife and 1 for material storage.

Size of land: 1040 Sq. Ft.

A short profile of Women Friendly Space (WFS): The IRC's innovative IWC's provide an integrated, multi-sector package of essential services enabling women and girls to access life-

saving protection and sexual and reproductive health services and support in one center. The centers, which are completely run by female staff and volunteers, are safe spaces in which beneficiaries can access the services they need in a safe, dignified, and confidential manner. Ensuring accessibility to the facilities and services of the multiple intersectional identities is one of the major priorities of IRC. GBV response and prevention is at the heart of the activities and the center which is staffed by trained service providers including case workers and midwives, to whom women and girls can safely disclose their individual experiences of GBV. In addition to these essential services, the IWCs offer women and girls a space in which to feel comfortable and enjoy the freedom to express themselves without the fear of being judged or harmed. Community mobilization interventions such curricula designed for adolescent girls and men and boys are also effective interventions to prevent diverse types of abuse, including physical and sexual intimate partner violence (IPV), emotional aggression, and controlling behaviors. These prevention interventions help to change attitudes and norms supportive of violence against women, promote gender equitable behaviors, and economically and socially empower women.